

THE UNITED REPUBLIC OF TANZANIA
MINISTRY OF ENERGY AND MINERALS

THE MINING (MINERAL RIGHTS) REGULATIONS, 2010

PRIMARY MINING LICENCE 012453EZ

The Mining Act, 2010

The exclusive right, subject to the provisions of the Mining Act, 2010 and of the regulations thereunder now in force or which may come into force during the continuance of this primary mining licence or any renewal thereof is hereby granted to **M/S Madhubuti Export and Import Products Ltd** of **P.O. Box 9461, Dar es Salaam-Tanzania** (hereinafter called the Licensee), to prospect and mine for **Building Materials**, at **Kinzagu** in **Bagamoyo District**, **QDS 167/4** over an area described in Annex A.

This Licence, unless sooner cancelled, suspended or surrendered pursuant to the provisions of the Mining Act, 2010, shall be valid for a period of **seven (7) years**, effective from the date of grant.

Granted this 01st day of September 2015



Eng. Hamisi M. Komba
ZONAL MINES OFFICER
Eastern Zone

ANNEX A

DESCRIPTION OF THE PRIMARY MINING LICENCE AREA

The Primary Mining Licence is at **Kinzagu** in **Bagamoyo District**, QDS 167/4 defined by the following corner co-ordinates (Arc 1960):

Corner	Latitude	Longitude
1	- 06 deg. 22 min. 17.76 sec.	38 deg. 16 min. 31.66 sec.
2	- 06 deg. 22 min. 21.39 sec.	38 deg. 16 min. 32.20 sec.
3	- 06 deg. 22 min. 22.45 sec.	38 deg. 16 min. 29.00 sec.
4	- 06 deg. 22 min. 18.10 sec.	38 deg. 16 min. 27.00 sec.

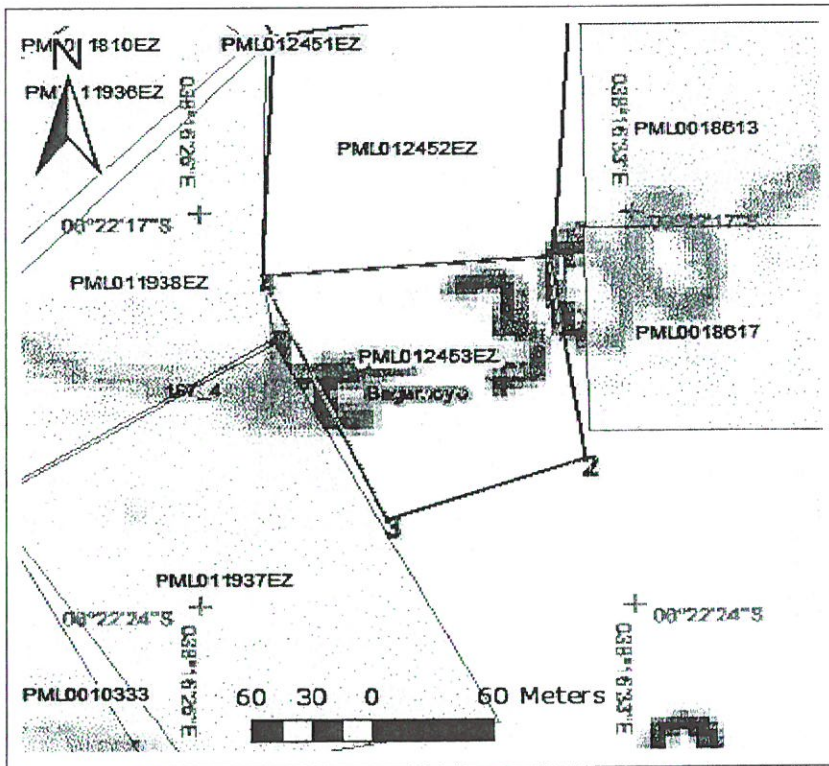

Legend	
Licensed area	
License Number	PML012453EZ
District	Bagamoyo
Direction	

An area of approximately **1.56 Hectares**.

ANNUAL RENT PAYMENTS

Year	ERV	Amount (TShs.)	Date	Signature & Stamp
1.	7000980	80,000/=	2015/16 28/08/15	<i>Kny: KAMISUWA MADINI</i> KANDAMU MASHARIKI DARIES SALAAM
2.	9643686	80,000/=	29/08/16	<i>[Signature]</i>
3.	19386700	80,000/=	26/01/2018	<i>[Signature]</i>
4.	28416477	90,000/=	09/10/2019	<i>[Signature]</i>
5.	28416477	90,000/=	09/10/2019	<i>[Signature]</i>
6.				
7.				

EXECUTIVE SECRETARY
MINING COMMISSION

THE UNITED REPUBLIC OF TANZANIA
MINISTRY OF ENERGY AND MINERALS

THE MINING (MINERAL RIGHTS) REGULATIONS, 2010

PRIMARY MINING LICENCE 012452EZ

The Mining Act, 2010

The exclusive right, subject to the provisions of the Mining Act, 2010 and of the regulations thereunder now in force or which may come into force during the continuance of this primary mining licence or any renewal thereof is hereby granted to **M/S Madhubuti Export and Import Products Ltd** of **P.O. Box 9461, Dar es Salaam-Tanzania** (hereinafter called the Licensee), to prospect and mine for **Building Materials** at **Kinzagu** in **Bagamoyo District**, **QDS 167/4** over an area described in Annex A.

This Licence, unless sooner cancelled, suspended or surrendered pursuant to the provisions of the Mining Act, 2010, shall be valid for a period of **seven (7) years**, effective from the date of grant.

Granted this^{01st} day of September.....2015

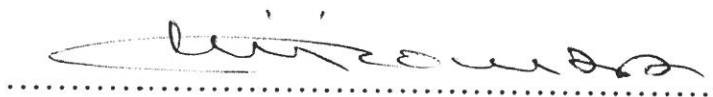

Eng. Hamisi M. Komba
ZONAL MINES OFFICER
Eastern Zone

ANNEX A

DESCRIPTION OF THE PRIMARY MINING LICENCE AREA

The Primary Mining Licence is at **Kir zagu** in **Bagamoyo** District, QDS 167/4 defined by the following corner co-ordinates (Arc 1960):

Corner	Latitude	Longitude
1	-06 deg. 22 min. 13.80 sec.	38 deg. 16 min. 27.20 sec.
2	-06 deg. 22 min. 13.10 sec.	38 deg. 16 min. 32.00 sec.
3	-06 deg. 22 min. 17.76 sec.	38 deg. 16 min. 31.70 sec.
4	-06 deg. 22 min. 18.10 sec.	38 deg. 16 min. 27.00 sec.

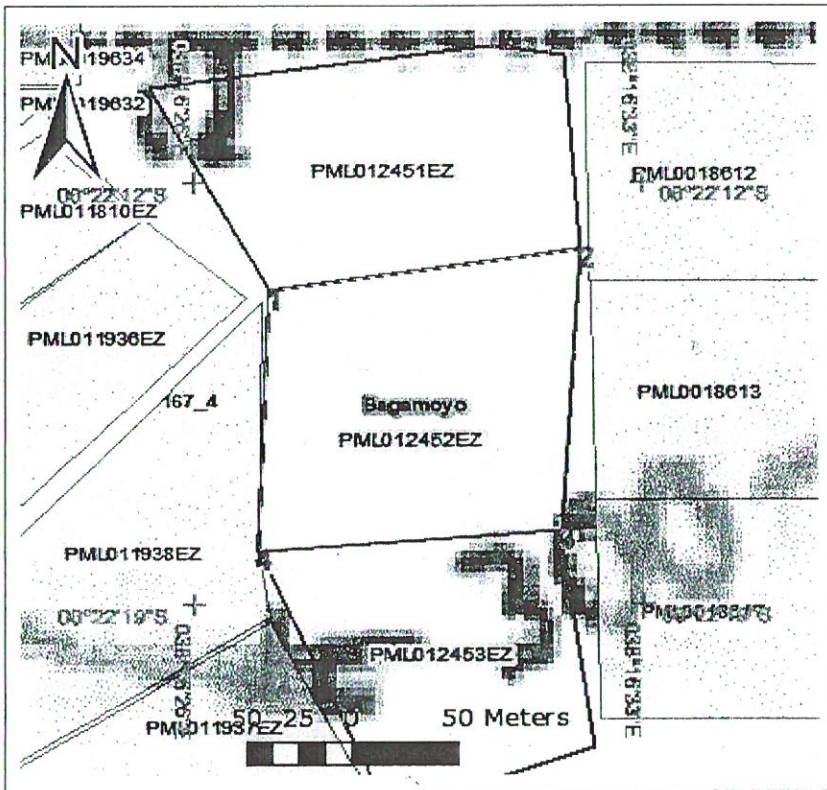

Legend	
Licensed area	
License Number	PML012452EZ
District	Bagamoyo
Direction	

An area of approximately 2.00 Hectares.

ANNUAL RENT PAYMENTS

Year	ERV	Amount (TShs.)	Date	Signature & Stamp
1.	7000980	80,000/=	2015/16 31/08/15	<i>Kny: KAMISHNA MSAIDIZI WA MADINI</i> <i>Signature & Stamp</i> <i>DAR (S) SALAAM</i>
2.	9643686	80,000/=	29/08/16	<i>Signature</i>
3.	19386700	80,000/=	26/07/2018	<i>Signature</i>
4.	28416477	90,000/=	09/10/2019	<i>Signature</i>
5.	28416477	90,000/=	09/10/2019	<i>Signature</i>
6.				
7.				

EXECUTIVE SECRETARIAT
FOR THE EXECUTIVE SECRETARIAT
MINING COMMISSION

THE UNITED REPUBLIC OF TANZANIA
MINISTRY OF MINERALS
MINING COMMISSION

THE MINING (MINERAL RIGHTS) REGULATIONS, 2018

PRIMARY MINING LICENCE 0118DSM

The Mining Act, Cap. 123

The exclusive right, subject to the provisions of *The Mining Act, Cap. 123* and the regulations made thereunder or which may come into force during the continuance of this primary mining licence or any renewal thereof is hereby granted to M/S **The Registered Trustees of Tanzania Assemblies of God of P.O. Box 11180, Dar es Salaam-Tanzania** (hereinafter called the Licensee), to prospect and mine for **Aggregates** at **Pongwe Msungura** in **Bagamoyo District, QDS 167/4** over an area described in Annex A.

This Licence, unless sooner cancelled, suspended or surrendered pursuant to the provisions of *The Mining Act, Cap. 123* shall be valid for a period of **seven (7)** years, effective from the date of grant.

Granted this 21st day of JANUARY 2019

.....



Eng. Ally S. Maganga
For: EXECUTIVE SECRETARY

ANNEX A

DESCRIPTION OF THE PRIMARY MINING LICENCE AREA

The Primary Mining Licence is at **Pongwe Mst. Mgura** in **Bagamoyo District**, QDS 167/4 defined by the following corner co-ordinates (A/c 1960):

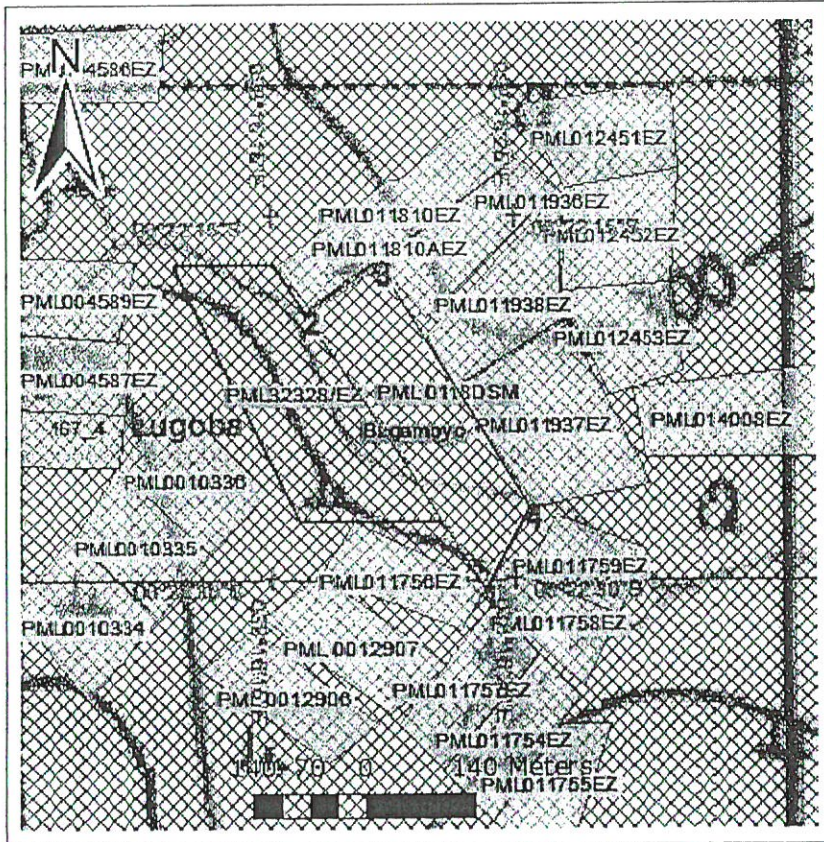
Corner	Latitude	Longitude
1	- 06 deg. 22 min. 30.32 sec.	38 deg. 16 min. 23.80 sec.
2	- 06 deg. 22 min. 19.00 sec.	38 deg. 16 min. 16.50 sec.
3	- 06 deg. 22 min. 17.00 sec.	38 deg. 16 min. 19.40 sec.
4	- 06 deg. 22 min. 27.00 sec.	38 deg. 16 min. 25.58 sec.



Legend	
Licensed area	
License Number	PML 0118DSM
District	Bagamoyo
Direction	

An area of approximately 4.04 Hectares.

ANNUAL RENT PAYMENTS

Year	ERV	Amount (TShs.)	Date	Signature & Stamp
1.	24443566	181,800/=	31.1.2019	
2.				
3.				
4.				
5.				
6.				
7.				

**THE UNITED REPUBLIC OF TANZANIA
MINISTRY OF ENERGY AND MINERALS**

THE MINING (MINERAL RIGHTS) REGULATIONS, 2010

PRIMARY MINING LICENCE 011938EZ

The Mining Act, 2010

The exclusive right, subject to the provisions of the Mining Act, 2010 and of the regulations thereunder now in force or which may come into force during the continuance of this primary mining licence or any renewal thereof is hereby granted to **M/S Madhubuti Export and Import Products Ltd of p.o Box 9461, Dar es salaam, Tanzania** (hereinafter called the Licensee), to prospect and mine for **Building Materials**, at **Kinzagu in Bagamoyo District, QDS 167/4** over an area described in Annex A.

This Licence, unless sooner cancelled, suspended or surrendered pursuant to the provisions of the Mining Act, 2010, shall be valid for a period of **seven (7) years**, effective from the date of grant.

Granted this 08th day of APRIL 2015

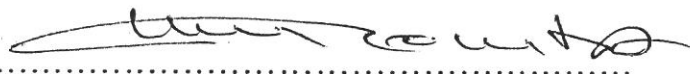
.....

Eng. Hamisi M. Komba
ZONAL MINES OFFICER
Eastern Zone

ANNEX A

DESCRIPTION OF THE PRIMARY MINING LICENCE AREA

The Primary Mining Licence is at **Kinzagu** in **Bagamoyo** District, QDS 167/4 defined by the following corner co-ordinates (Arc 1960):

Corner	Latitude	Longitude
1	- 06 deg. 22 min. 19.19 sec.	38 deg. 16 min. 27.20 sec.
2	- 06 deg. 22 min. 22.01 sec.	38 deg. 16 min. 22.56 sec.
3	- 06 deg. 22 min. 19.80 sec.	38 deg. 16 min. 21.30 sec.
4	- 06 deg. 22 min. 13.98 sec.	38 deg. 16 min. 27.05 sec.
5	- 06 deg. 22 min. 18.08 sec.	38 deg. 16 min. 26.99 sec.

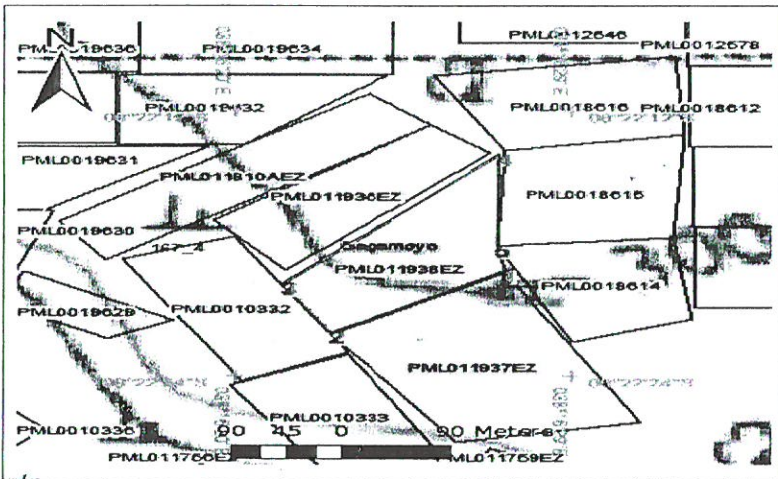

Legend	
Licensed area	
License Number	PML011938EZ
District	Bagamoyo
Direction	

An area of approximately 2.06 Hectares.

ANNUAL RENT PAYMENTS

Year	ERV	Amount (TShs.)	Date	Signature & Stamp
1.	4372856	82,400/=	2015/2016 23/02/2015	For: ASSISTANT COMMISSIONER FOR MIN. EASTERN ZONE
2.	5114828	82,400/=	2016/17 18/04/2016	For: ASSISTANT COMMISSIONER FOR MINERALS EASTERN ZONE
3.	13992689	82,400/=	2017/18 04/04/17	For: ASSISTANT COMMISSIONER FOR MINERALS EASTERN ZONE
4.	19395157	82,400/=	05/04/2018	For: EXECUTIVE SECRETARY MINING COMMISSION
5.	27607962	92,700/=	11/04/2019	
6.				
7.				

THE UNITED REPUBLIC OF TANZANIA
MINISTRY OF ENERGY AND MINERALS

THE MINING (MINERAL RIGHTS) REGULATIONS, 2010

PRIMARY MINING LICENCE 011937EZ

The Mining Act, 2010

The exclusive right, subject to the provisions of the Mining Act, 2010 and of the regulations thereunder now in force or which may come into force during the continuance of this primary mining licence or any renewal thereof is hereby granted to **M/S Madhubuti Export and Import Products Ltd of p.o Box 9461, Dar es salaam, Tanzania** (hereinafter called the Licensee), to prospect and mine for **Building Materials**, at **Kinzagu in Bagamoyo District, QDS 167/4** over an area described in Annex A.

This Licence, unless sooner cancelled, suspended or surrendered pursuant to the provisions of the Mining Act, 2010, shall be valid for a period of **seven (7) years**, effective from the date of grant.

Granted this 08th day of APRIL 2015

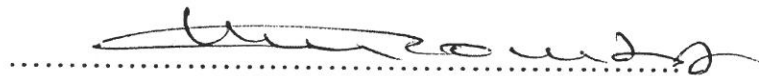

Eng. Hamisi M. Komba
ZONAL MINES OFFICER
Eastern Zone

THE UNITED REPUBLIC OF TANZANIA
MINISTRY OF ENERGY AND MINERALS

THE MINING (MINERAL RIGHTS) REGULATIONS, 2010

PRIMARY MINING LICENCE 012451EZ

The Mining Act, 2010

The exclusive right, subject to the provisions of the Mining Act, 2010 and of the regulations thereunder now in force or which may come into force during the continuance of this primary mining licence or any renewal thereof is hereby granted to **M/S Madhubuti Export and Import Products Ltd** of **P.O. Box 9461, Dar es Salaam-Tanzania** (hereinafter called the Licensee), to prospect and mine for **Building Materials** at **Kinzagu** in **Bagamoyo District**, **QDS 167/4** over an area described in Annex A.

This Licence, unless sooner cancelled, suspended or surrendered pursuant to the provisions of the Mining Act, 2010, shall be valid for a period of **seven (7) years**, effective from the date of grant.

Granted this^{01st} day ofSeptember.....2015

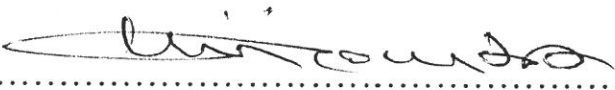

Eng. Hamisi M. Komba
ZONAL MINES OFFICER
Eastern Zone

ANNEX A

DESCRIPTION OF THE PRIMARY MINING LICENCE AREA

The Primary Mining Licence is at **Kinzagu** in **Bagamoyo** District, QDS 167/4 defined by the following corner co-ordinates (Arc 1960):

Corner	Latitude	Longitude
1	- 06 deg. 22 min. 13.10 sec.	38 deg. 16 min. 32.00 sec.
2	- 06 deg. 22 min. 13.80 sec.	38 deg. 16 min. 27.20 sec.
3	- 06 deg. 22 min. 10.41 sec.	38 deg. 16 min. 25.29 sec.
4	- 06 deg. 22 min. 9.71 sec.	38 deg. 16 min. 30.59 sec.
5	- 06 deg. 22 min. 9.90 sec.	38 deg. 16 min. 31.75 sec.

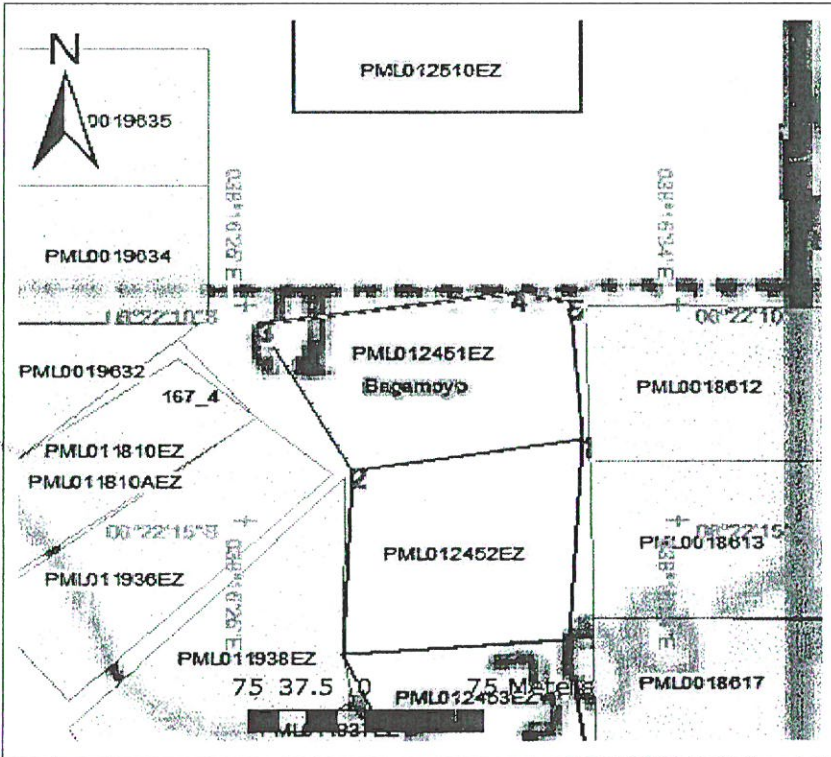

Legend	
Licensed area	
License Number	PML012451EZ
District	Bagamoyo
Direction	

An area of approximately **1.90 Hectares**.

ANNUAL RENT PAYMENTS

Year	ERV	Amount (TShs.)	Date	Signature & Stamp
1.	7000980	80,000/-	2015/16 31/08/15	Kny: KANDA YAKIMASHARIKI DAMAS SALAAM
2.	9643686	80,000/-	29/08/16	
3.	19386700	80,000/-	28/01/2018	
4.	28416477	90,000/-	09/10/2019	
5.	28416477	90,000/-	09/10/2019	
6.				
7.				

EXECUTIVE SECRETARY
MINING COMMISSION
FOR EXECUTIVE SECRETARY
MINING COMMISSION

**THE UNITED REPUBLIC OF TANZANIA
MINISTRY OF ENERGY AND MINERALS**

THE MINING (MINERAL RIGHTS) REGULATIONS, 2010

PRIMARY MINING LICENCE 011936EZ

The Mining Act, 2010

The exclusive right, subject to the provisions of the Mining Act, 2010 and of the regulations thereunder now in force or which may come into force during the continuance of this primary mining licence or any renewal thereof is hereby granted to **M/S Madhubuti Export and Import Products Ltd** of **p.o Box 9461, Dar es salaam, Tanzania** (hereinafter called the Licensee), to prospect and mine for **Building Materials**, at **Kinzagu in Bagamoyo District, QDS 167/4** over an area described in Annex A.

This Licence, unless sooner cancelled, suspended or surrendered pursuant to the provisions of the Mining Act, 2010, shall be valid for a period of **seven (7) years**, effective from the date of grant.

Granted this ^{08th} day of APRIL 2015

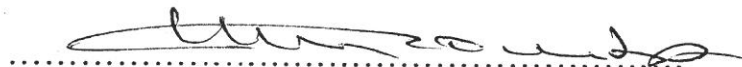

Eng. Hamisi M. Komba
ZONAL MINES OFFICER
Eastern Zone

THE UNITED REPUBLIC OF TANZANIA
MINISTRY OF ENERGY AND MINERALS

THE MINING (MINERAL RIGHTS) REGULATIONS, 2010

PRIMARY MINING LICENCE 011810EZ

The Mining Act, 2010

The exclusive right, subject to the provisions of the Mining Act, 2010 and of the regulations thereunder now in force or which may come into force during the continuance of this primary mining licence or any renewal thereof is hereby granted to **M/S Madhubuti Export and Import Products Ltd** of **p.o Box 9461, Dar es salaam, Tanzania** (hereinafter called the Licensee), to prospect and mine for **Building Materials** at **Kinzagu** in **Bagamoyo District, QDS 167/4** over an area described in Annex A.

This Licence, unless sooner cancelled, suspended or surrendered pursuant to the provisions of the Mining Act, 2010, shall be valid for a period of **seven (7) years**, effective from the date of grant.

Granted this ^{08th} day of APRIL 2015



Eng. Hamisi M. Komba
ZONAL MINES OFFICER
Eastern Zone

ANNEX A

DESCRIPTION OF THE PRIMARY MINING LICENCE AREA

The Primary Mining Licence is at **Kinzagu** in **Bagamoyo District**, QDS 167/4 defined by the following corner co-ordinates (Arc 1960):

Corner	Latitude	Longitude
1	- 06 deg. 22 min. 12.60 sec.	38 deg. 16 min. 25.20 sec.
2	- 06 deg. 22 min. 18.77 sec.	38 deg. 16 min. 16.56 sec.
3	- 06 deg. 22 min. 17.00 sec.	38 deg. 16 min. 15.32 sec.
4	- 06 deg. 22 min. 11.20 sec.	38 deg. 16 min. 23.56 sec.

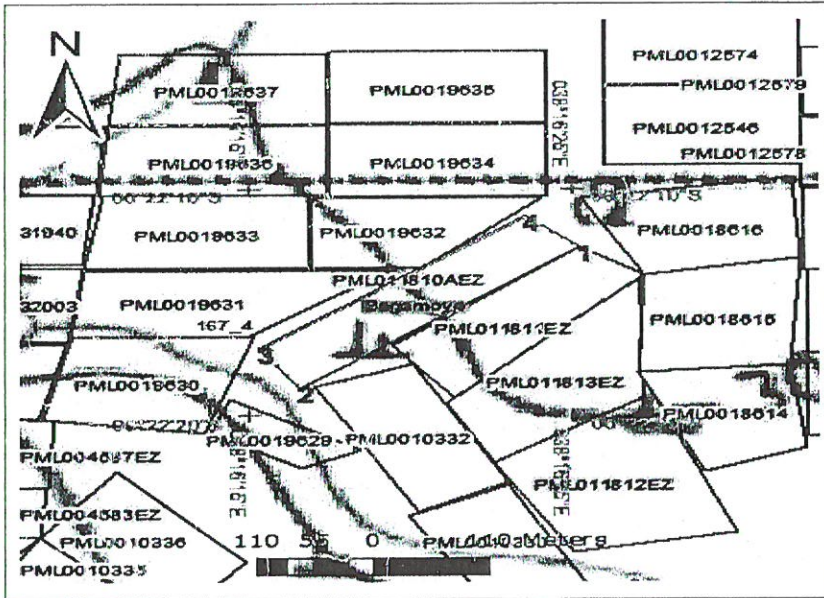

Legend	
Licensed area	
License Number	PML011810AEZ
District	Bagamoyo
Direction	

An area of approximately 2.08 Hectares.

ANNUAL RENT PAYMENTS

Year	ERV	Amount (TShs.)	Date	Signature & Stamp
1.	A372856	83,200/=	2015/2016 23/02/2015	For: ASSISTANT COMMISSIONER FOR MINERALS EASTERN ZONE
2.	S14828	83,200/-	2016/17 18/04/2017	For: ASSISTANT COMMISSIONER FOR MINERALS EASTERN ZONE
3.	13992669	83,200/=	2017/18 4/4/2017	For: ASSISTANT COMMISSIONER FOR MINERALS EASTERN ZONE
4.	19395157	83,200/=	05/04/2018	For: EXECUTIVE SECRETARY MINING COMMISSION
5.	27607962	93,600/=	11/04/2019	For: EXECUTIVE SECRETARY MINING COMMISSION
6.	28416477	93,600/-	09/10/2019	For: EXECUTIVE SECRETARY MINING COMMISSION
7.				