

TITLE No. 31730

REGISTERED ON  
21-3-2011  
9.20 A.



Land Form No.22

M. M. Mway  
Asst. Registrar of Lands

Stamp Duty No. 1001 =  
and Revenue Receipt No. 29128400  
of 29-9-2007  
M. M. Mway  
Duty

**THE UNITED REPUBLIC OF TANZANIA**

**THE LAND ACT, 1999  
NO.4 OF 1999**

**TANGANYIKA CERTIFICATE OF OCCUPANCY**

STAMP DUTY PAID ON (Under Section 29)  
ORIGINAL No. 371201 =  
Receipt No. 29128400 29-9-07  
M. M. Mway  
Duty Asst. Registrar of Lands

Title No. 31730 L.R. Mwanza  
L.O. No. 192797. 182797  
L.D.NO.SH/19171. GCBRIAL

The 15<sup>th</sup> day of March, Two thousand and **Eleven**

THIS IS TO CERTIFY that **ANDREW JOHN CHENGE** P. O. BOX **11958 DAR ES SALAAM** (hereinafter called "the Occupiers") are entitled to a right of occupancy (hereinafter called "the Right") in and over the land described in the Schedule hereto (herein after called "the Land") as occupants in common in equal shares for a term of **Ninety Nine** years from the **first day of July, Two thousand and seven** according to the true intent and meaning of the land Act and subject to the provisions thereof and to any regulations made there under and to any enactment in substitution therefore or amendment thereof and to the following special conditions:-

1. The Occupiers having paid rent up to the thirtieth day of June, **2008**, shall thereafter pay rent of shillings **Seven hundred fifty two thousand five hundred (Tshs.752,500/=)** only a year in advance on the **first day of July** in every year of the term without deduction PROVIDED that the rent may be revised by the Commissioner for Lands.
2. The land shall be used only for **Agricultural and Animal Husbandry purposes only. Use Group 'R' Use Classes (a) and (c)** as defined in the town and country Planning (Use Classes) Regulations, 1960 **as amended in 1993.**

3. The Occupier shall:-

- a) Plant trees all around the farm boundaries
- b) Demarcate the boundaries of the land to the satisfaction of **Shinyanga Municipal Council** (hereinafter called "the Authority") and thereafter to maintain such demarcation that the boundaries are always easily identifiable.
- c) Do everything necessary to preserve the environment and protect the soil and prevent soil erosion on the land and do all things which may be required by the authorities responsible for environment and to achieve such objective.
- d) Be responsible for the protection of all beacons on the land throughout the term of the Right. Missing beacons will have to be re-established at any time at the Occupiers expenses as assessed by the authority responsible for Surveys and mapping.

4. The following are the rights of the Occupier:-

- a) The permanent exclusive right to the land, the subject of the right of occupancy against all persons other than the Commissioner.
- b) The rights shall confer no water Rights

5. The Occupier shall not assign the Right within three years of the date hereof without the prior approval of the Commissioner for Land.

6. The Occupier shall deliver to the Commissioner for Lands notification of disposition in prescribed form before or at the time the disposition is carried out together with the payment of all premia taxes and dues prescribed in connection with that disposition.

7. The President may revoke the right for good cause or in public interest.

# SHINYANGA MUNICIPALITY

Locality CHIBE  
 Block             
 Plot No. / Farm no. 1  
 L.O. No. 182797  
 Area 602280 sq. ft. / sq. m.

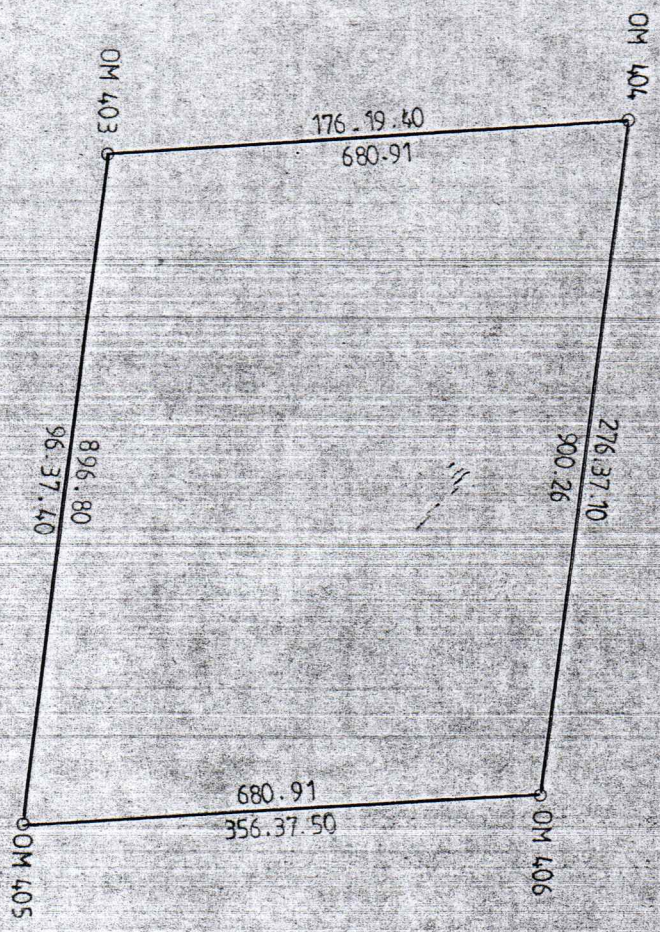

The issue of this plan implies no guarantee or admission of title by the Government.

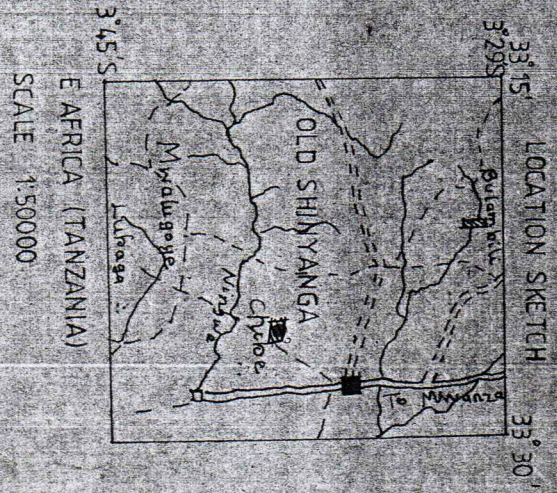

This plan prepared in accordance with Registered plan No. 21842 is approved for the purpose of Land Registration Ordinance.  
 Director of Surveys and Mapping  
 Ministry of Lands, Natural Resources and Tourism, Dar es Salaam  
 Date: 2/10/2007

**SCHEDULE**

**ALL** land known as **Farm No.1 Chibe (Urban Farming)** in **Shinyanga Municipality** containing **Six hundred and two thousand two hundred eighty (602280)** shown for identification only edged **red** on the plan attached to this Certificate and defined on the registered Survey Plan Numbered **21842** deposited at the office of the Director for Surveys and Mapping at Dar es Salaam.

**GIVEN** under my hand and my official seal the day and year first above written.

*[Signature]*  
**Asst COMMISSIONER FOR LANDS**

**I, ANDREW JOHN CHENGE** the within named **HEREBY** accept the terms and conditions contained in the foregoing Certificate of Occupancy.

**SIGNED** and **DELIVERED** by the said **ANDREW JOHN CHENGE** who is known to me personally/ identified to me by.....

.....  
the latter being known to me personally in my presence this 17<sup>th</sup> day of Feb 2011.

Witness's

Signature:.....

Postal Address:.....

Qualification:.....

*[Signature]*  
**963 DODOMA**  
**STATE ATTORNEY**

