



DAR ES SALAAM ZONAL OFFICE  
 PO BOX 1191, DAR ES SALAAM  
 Tel: No. +255 22 2120458  
 Fax: No. +255 22 212 4576  
 E-mail: smd@ardhi.go.tz



THE UNITED REPUBLIC OF TANZANIA  
 MINISTRY OF LANDS, HOUSING AND HUMAN SETTLEMENTS DEVELOPMENT  
 SURVEY AND MAPPING DIVISION

**SURVEY PLAN**

SUERVEY OF PLOTS..... AT KIGOGO KISARAWE II KIGAMBONI MUNICIPALITY IN DSM CITY

Registered Plan No: DSMS0024207

Instruction to Survey No: DSMI0012607

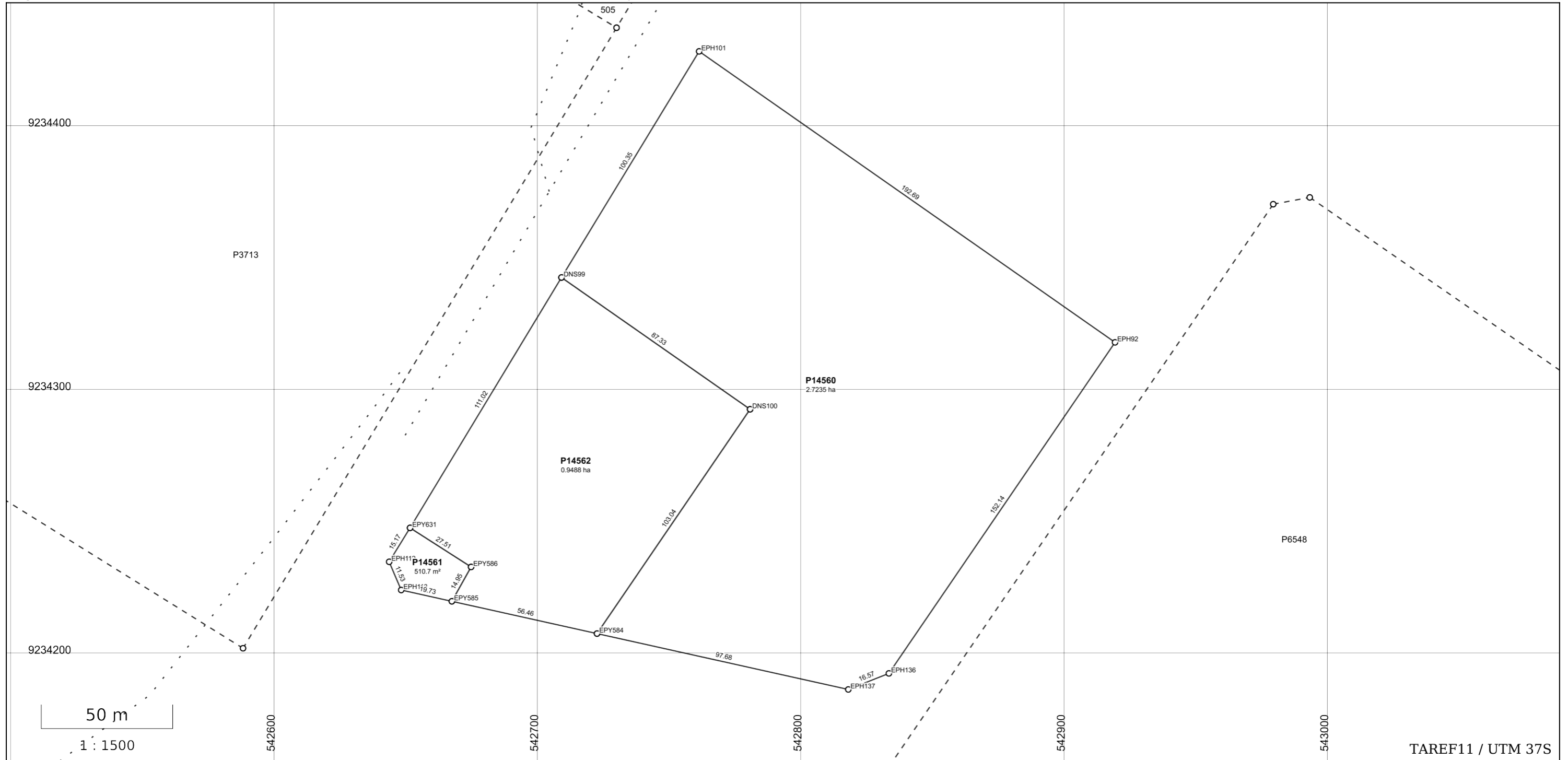

Region: Dar es Salaam  
 District: Kigamboni Municipal Council  
 Location: Kigogo Kisarawe II  
 Block:  
 Plot No: P14560-P14562



Plan generated from parcels approved on the 30<sup>th</sup> day of June 2021 by Geoffrey Kameta, Surveyor In charge.

I hereby certify that the survey represented by this plan was carried out in accordance with the survey regulations.

Geoffrey Kameta  
 Surveyor In charge

**LOCATION SKETCH**

---

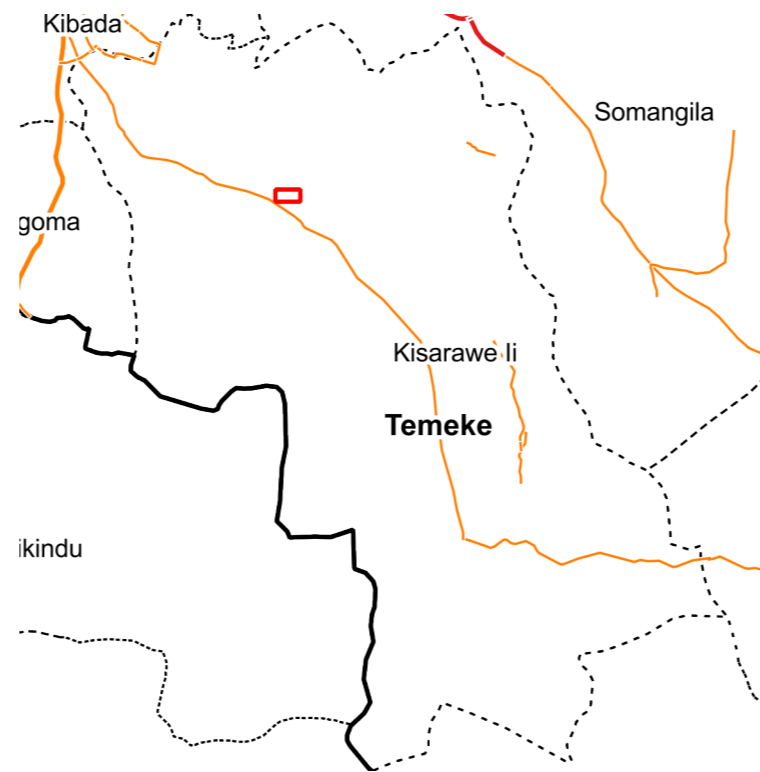

**COORDINATES OF BEACONS (Easting, Northings): TAREF11 / UTM 37S**

---

<i>DNS100:</i>	542 780.79, 9 234 292.43
<i>DNS99:</i>	542 709.18, 9 234 342.42
<i>EPH101:</i>	542 761.44, 9 234 428.20
<i>EPH112:</i>	542 643.75, 9 234 234.57
<i>EPH113:</i>	542 648.32, 9 234 223.86
<i>EPH136:</i>	542 833.49, 9 234 192.23
<i>EPH137:</i>	542 818.08, 9 234 186.14
<i>EPH92:</i>	542 919.36, 9 234 317.82
<i>EPY584:</i>	542 722.67, 9 234 207.34
<i>EPY585:</i>	542 667.55, 9 234 219.58
<i>EPY586:</i>	542 674.86, 9 234 232.62
<i>EPY631:</i>	542 651.68, 9 234 247.44

**COORDINATES OF IPC (Easting, Northings): TAREF11 / UTM 37S**

---