

SURVEY OF PLOTS No. 122-124 BLOCK "A" MALULA  
ARUMERU DISTRICT - ARUSHA REGION

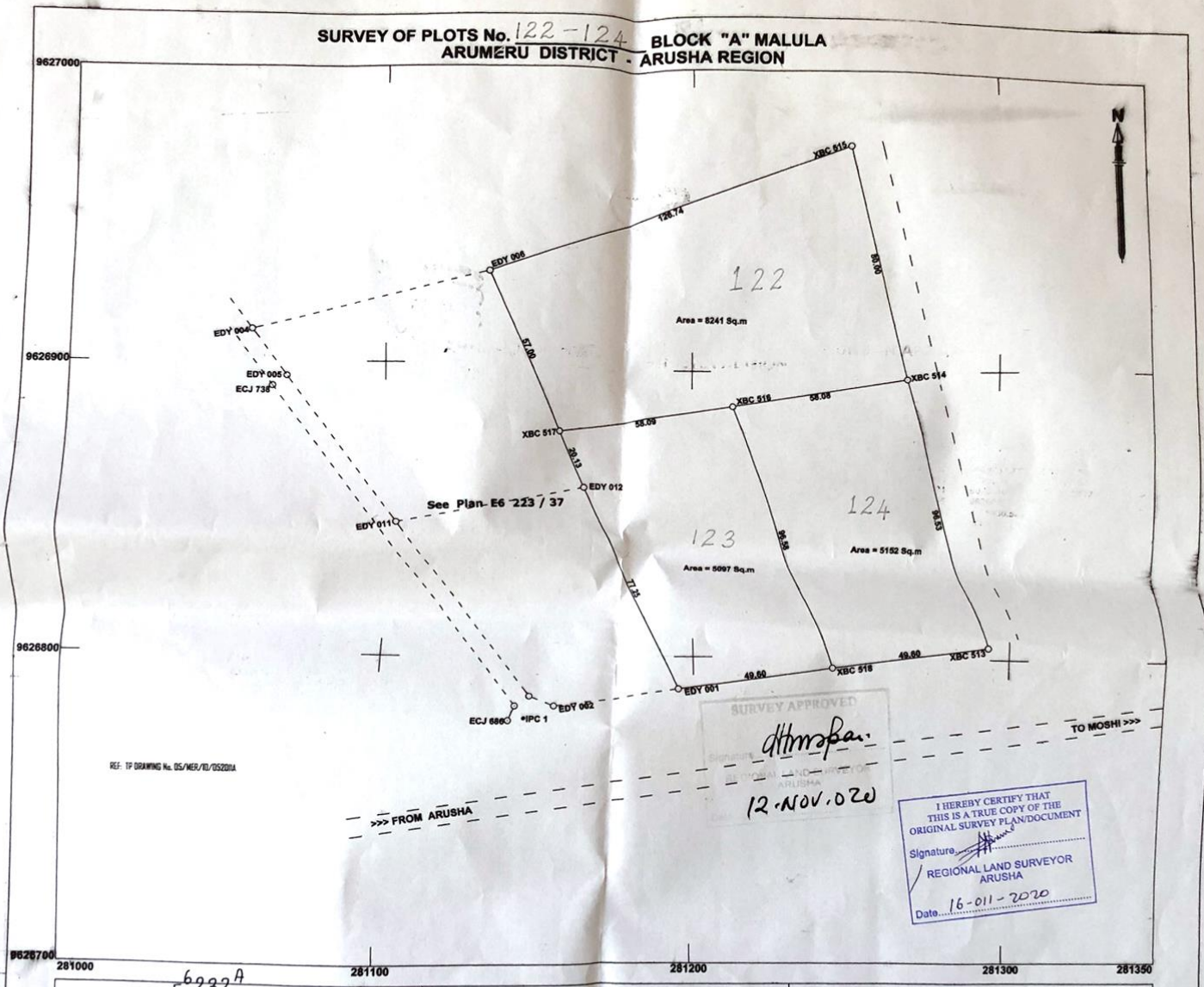

REF: TP DRAWING No. 05/MER/10/052014

SURVEY APPROVED  
*dtm*  
12.NOV.020

I HEREBY CERTIFY THAT THIS IS A TRUE COPY OF THE ORIGINAL SURVEY PLAN/DOCUMENT  
Signature: *[Signature]*  
REGIONAL LAND SURVEYOR  
ARUSHA  
Date: 16-01-2020

COMPS No. E 232 A  
STD SHEET No. 55 III  
MP No. 55 III / 11 No I II  
PLAN No. E<sup>6</sup> 232 / 1045

Scale: 1:1000  
Amendments by:  
(1) Fendo (Plot no) 10.11.2020  
(2) \_\_\_\_\_  
(3) \_\_\_\_\_  
Photostat copies sent to:  
(1) \_\_\_\_\_  
(2) \_\_\_\_\_  
(3) \_\_\_\_\_

Plan drawn by Jack Perry, 2020  
I hereby certify that the survey represented by this plan was carried out in accordance with the survey regulations.  
Date: 03<sup>rd</sup> November 2020  
LOUISIANA SURVEYOR *[Signature]*  
REGISTERED PLAN No. 119240

1003