

MOSHI TOWNSHIP



INSET SHOWING DETAILS OF PLOT

LOCALITY SECTION IV MAJENGO

BLOCK 'E E E'

PLOT NO. 10

L.O. NO. 42345

AREA 2,619 SQ. M.

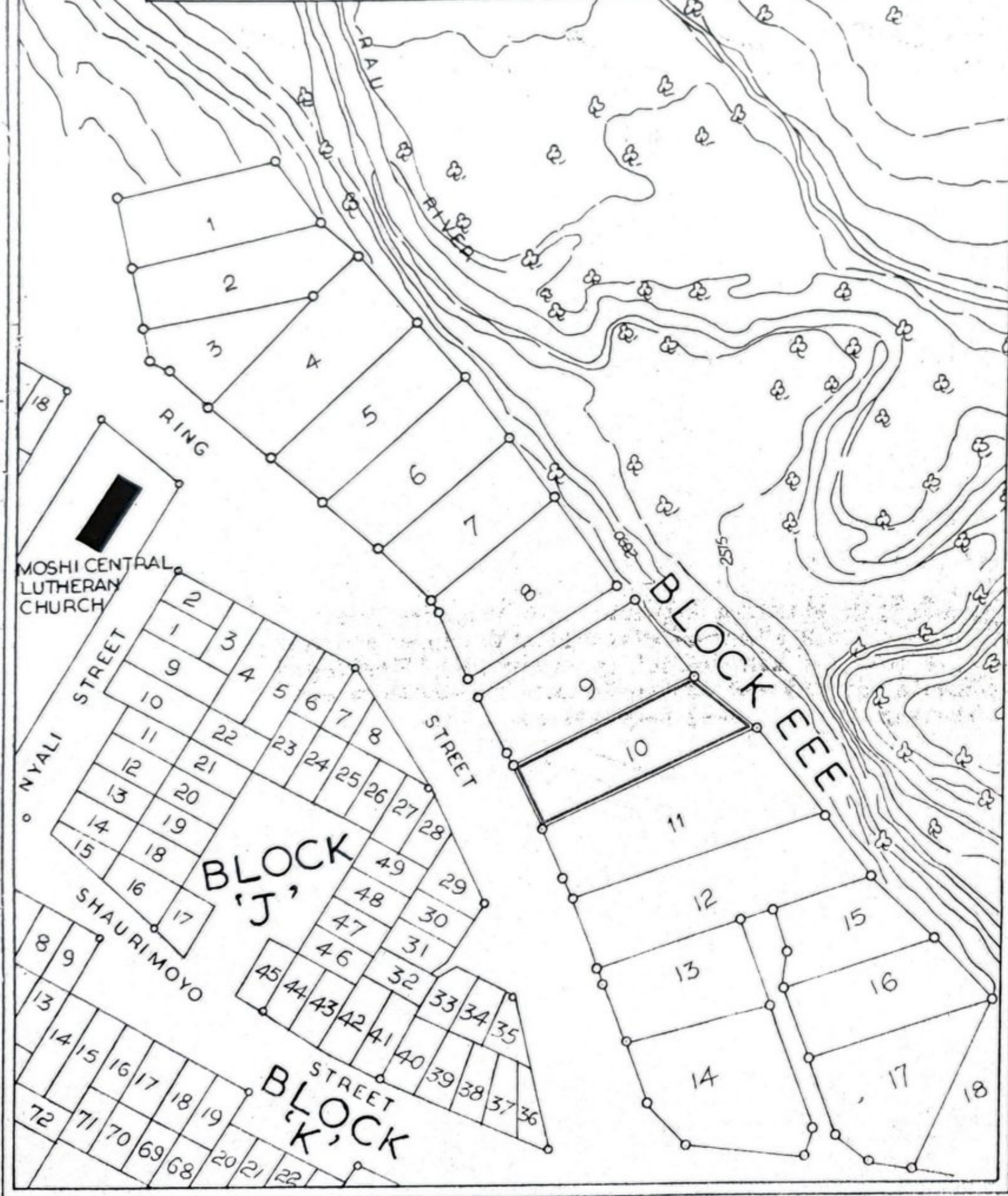
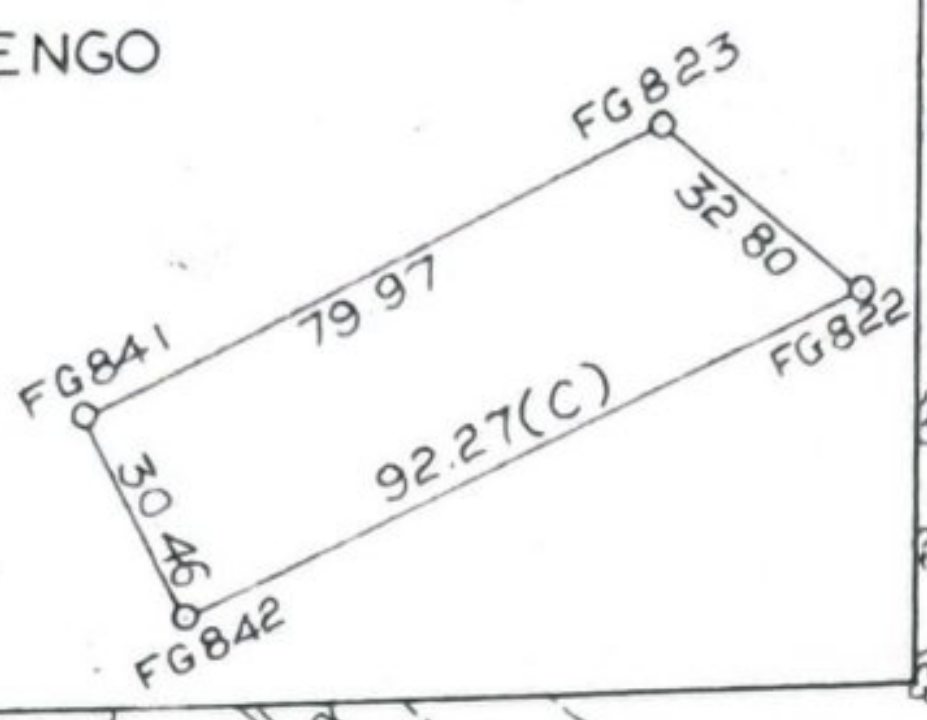

The issue of this plan implies no guarantee or admission of title by the Government.

This plan, prepared in accordance with Registered Plan No. 18329, is approved for the purpose of the Land Registration Act by the Director of Surveys and Mapping on 12/9/1979. Ministry of Lands, Housing and Urban Development. BY O.MARU V.G.S. 1979

LAND REGISTRY, MOSHI
 CERTIFICATE OF OWNERSHIP (S.67)

Filed Document No. 19831

Date of registration 23-6-2006 time 1:00 P.m.

To ZAWADI JANUARY of P.O. BOX 35059
 Dar es Salaam, as legal personal
 representative of JANUARY
 KIWERA, deceased.

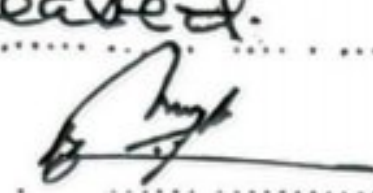

 Asst. Registrar of Titles

LAND REGISTRY, MOSHI
 ASSENT TO THE BEQUEST (S.68)

Filed Document No. 19832

Date of registration 23-6-2006 time 1:00 P.m.

To ZAWADI JANUARY
 of P.O. Box 149, MOSHI.



 Asst. Registrar of Titles

LAND REGISTRY, MOSHI
 TRANSFER

Filed Document No. 19833

Date of registration 23-6-2006 time 1:00 P.m.

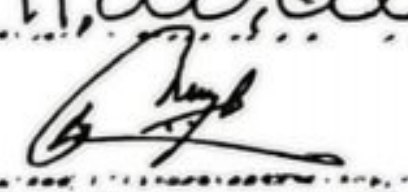
To CHRISTOPHER SHAYO
 of P.O. Box 149, MOSHI
 (CONS. TSHS. 11,000,000/-)



 Asst. Registrar of Titles

LAND REGISTRY, MOSHI
 TRANSFER

Filed Document No. 36739

Date of registration 7.10.2013 time 01:00 P.m.

To JONATHAN CHRISTOPHER SHAYO
 and VICTORIA JONATHAN SHAYO
 of P.O. Box 149, MOSHI. As joint
 tenants (Cons. Natural Love and Affection)



 Asst. Registrar of Titles

LAND REGISTRY, MOSHI
 TRANSFER

Filed Document No. 55109

Date of registration 15.1.2021 time 11:00A.m.

To VIOLETTA KISAMO
 of P.O. Box 1419 MOSHI.
 (Cons of 1 sh. 70000,000/-)

 Asst. Registrar of Titles

2059
 26-3-80
 9.15 A.M.
 George P. ...
 Land Form 32
 Asst. Registrar of Titles



L.O. No. 42345
 K.L.D. No. 818

THE UNITED REPUBLIC OF TANZANIA

CERTIFICATE OF OCCUPANCY

(Section 9 of the Land Ordinance)

The Eighty day of February, One thousand
 nine hundred and ~~seventy-nine~~ eighty-nine
 TITLE No. 2059 LAND REGISTRY - MOSHI

THIS IS TO CERTIFY that JANUARY KIWERA as a guardian of JOSEPH WAWA (Minor) OF P.O. BOX 115, MOSHI.

(hereinafter called "the Occupier") is entitled to a Right of Occupancy (hereinafter called "the Right") in and over the land described in the Schedule hereto (hereinafter called "the Land") ~~for a term of Ninety-nine years from the first day of~~ for a term of Ninety-nine years from the first day of

July One thousand nine hundred and ~~seventy eight~~ seventy eight according to the true intent and meaning of the Land Ordinance and subject to the provisions thereof and to any regulations made thereunder and to any enactment in substitution therefor or amendment thereof and to the following special conditions:—

1. The Occupier having paid rent up to the thirtieth day of June 1979, shall thereafter pay rent of shillings One hundred and fifty (Shs. 150/-) a year in advance on the first day of July in every year of the term without any deduction PROVIDED that the rent may be revised by the Minister for the time being responsible for Lands (hereinafter called "the Minister") on the first day of July in each of the years 1988, 1998, 2003, 2018, 2028, 2038, 2048, 2058 and 2068 — or within three years thereafter in each case.

2. The Occupier shall:—
- (i) Erect on the land buildings (hereinafter called "the buildings") in permanent materials designed for use in accordance with the conditions of the Right and which conform to the building line (if any) decided by the Moshi Town Council (hereinafter called "the Authority").
 - (ii) By the thirty first day of December 1978, submit to the Authority such plans for the buildings (including block plans showing the position of the buildings) and such drawings, elevation and specifications of them as will satisfy the Authority and as are in accordance with the building condition in sub-paragraph (i) above which said plans and specifications shall be submitted in triplicate;
 - (iii) Within six months from the date of notification by the Authority of approval of the plans and specifications referred to in sub-paragraph (ii) above begin building on the land in accordance with such plans and specifications;
 - (iv) Complete the buildings according to the plans and specifications so that they are ready for use and occupation by the thirtieth day of June 1981;
 - (v) At all times during the term after the thirtieth day of June 1981, have on the land buildings as approved by the Authority and maintain them in good order and repair to the satisfaction of the Commissioner for Lands (hereinafter called "the Commissioner");

Stamp Duty Shs. <u>4/-</u> Paid	Stamp Duty Shs. <u>8/-</u> Paid
and Revenue Receipt No. <u>379110</u>	on Original Revenue Receipt No. <u>379110</u>
of <u>11-9-78</u> issued.	of <u>11-9-78</u>
<u>George P. ...</u> Asst. Registrar of Titles	<u>George P. ...</u> Asst. Registrar of Titles

MOSHI TOWNSHIP

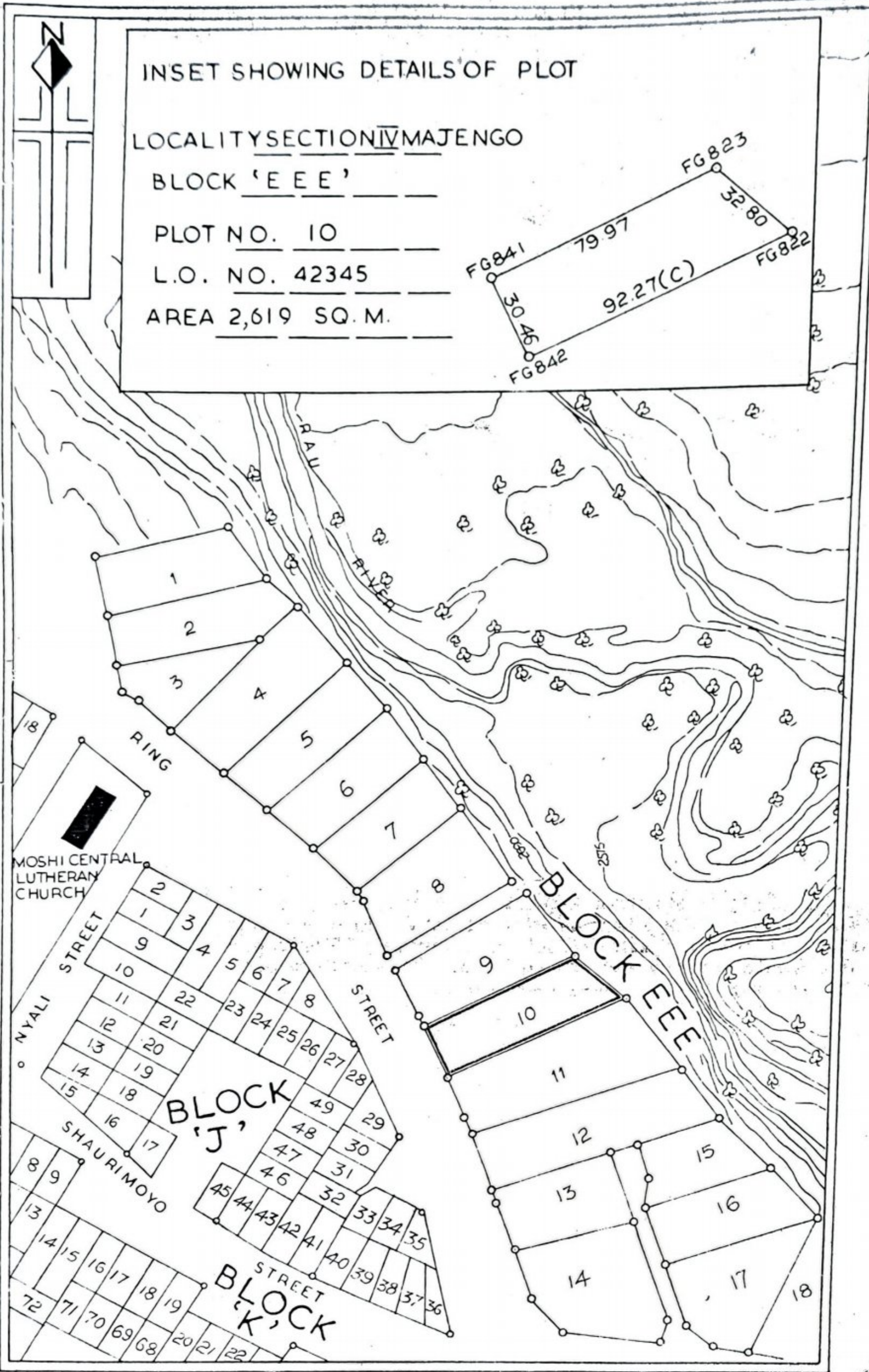

INSET SHOWING DETAILS OF PLOT

LOCALITY SECTION IV MAJENGO

BLOCK 'E E E'

PLOT NO. 10

L.O. NO. 42345

AREA 2,619 SQ. M.

The issue of this plan implies no guarantee or admission of title by the Government.

This plan, prepared in accordance with Registered Plan No. 18329, is approved for the purpose of the Land Registration Act, 1962, by the Director of Surveys and Mapping, Ministry of Lands, Housing and Urban Development, on 12/9/1979.

BY O.M.A.R.L.V.G.S. 1979

LAND REGISTRY, MOSHI
 CERTIFICATE OF OWNERSHIP (S.67)

Filed Document No. 19831

Date of registration 23-6-2006 time 1:00 P.m.

To ZAWADI JANUARY of P.O. BOX 35059
 Dar el Selem, as legal personal
 representative of JANUARY
 KIWERA, deceased.

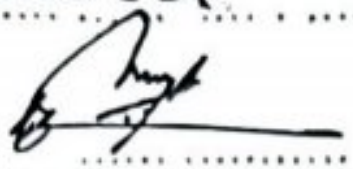

 Asst. Registrar of Titles

LAND REGISTRY, MOSHI
 ASSENT TO THE BEQUEST (S.68)

Filed Document No. 19832

Date of registration 23-6-2006 time 1:00 P.m.

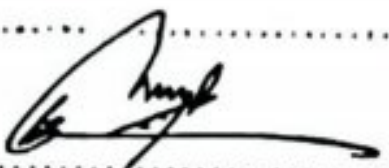
To ZAWADI JANUARY
 of P.O. Box 149, MOSHI.



 Asst. Registrar of Titles

LAND REGISTRY, MOSHI
 TRANSFER

Filed Document No. 19833

Date of registration 23-6-2006 time 1:00 P.m.

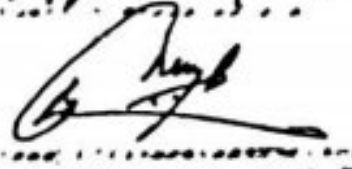
To CHRISTOPHER SHAYO
 opp. P.O. Box 149, MOSHI
 (CONS. TSHS. 11,000,000/-)



 Asst. Registrar of Titles

LAND REGISTRY, MOSHI
 TRANSFER

Filed Document No. 36739

Date of registration 7.10.2013 time 01:00 P.m.

To JONATHAN CHRISTOPHER SHAYO
 and VICTORIA JONATHAN SHAYO
 of P.O. Box 149, MOSHI. As Joint
 tenants (Cons. Natural Love and Affection)



 Asst. Registrar of Titles

LAND REGISTRY, MOSHI
 TRANSFER

Filed Document No. 55109

Date of registration 15.1.2021 time 11:00 A.m.

To VIOLET ERINA KISAMO
 P.O. Box 1419 MOSHI.
 (Cons of 1sh. 79,000,000/-)

 Asst. Registrar of Titles