



JAMHURI YA MUUNGANO WA TANZANIA  
OFISI YA RAIS  
TAWALA ZA MIKOA NA SERIKALI ZA MITAA  
HALMASHAURI YA WILAYA YA IGUNGA



Simu: +255 (026)2650019 (G/L)  
+255(026)2650021 (D/L)  
Nukushi: +255 (026)2650242  
Barua pepe: [ded@igungadc.go.tz](mailto:ded@igungadc.go.tz)  
Tovuti: <http://www.igungadc.go.tz>

Halmashauriya Wilaya,  
S.L.P 19,  
IGUNGA.

Unapojibutafadharitaja  
Kumbu.Na.HWIG/L.2/ I VOL.II/702

Tarehe 08/12/2022

MKURUGENZI MTENDAJI,  
KITUO CHA UWEKEZAJI,  
S.L.P 938,  
MTAA WA SHABAN ROBERT,  
DAR ES SALAAM.

**YAH: ENEO LINALOMILIKIWA NA M'COIN LIMITED**

M'coin Limited ni kampuni ambayo inafanya shughuli za madini katika Halmashauri ya Igunga hadi kwa hatua ya upandishaji thamani wa madini hayo ya Dhahabu.

2. Kwa barua hii, naitambulisha M'coin Limited kuwa ni wamiliki wa eneo wanapofanyia kazi ambapo walilipa fidia wananchi na kununua eneo hilo, na hawana mgogoro wowote, na wamekuwa eneo la uwanda kwa muda usiopugua miaka mitatu (3). Kwa sasa eneo lina mpango kina na lipo hatua ya mwisho ya upimaji.

3. Naomba uwapatie msaada ili waweze kumilikishwa eneo hilo kwa mujibu wa sheria.

4. Natanguliza shukrani.

  
Jahulula E. Jahulula  
K.n.y MKURUGENZI MTENDAJI  
HALMASHAURI YA WILAYA  
IGUNGA

**Nakala:**

- Kaimu Mkurugenzi Mtendaji  
S.L.P 19  
IGUNGA
- Aione kwenye Jalada
- Katibu Tawala  
S.L.P 5  
IGUNGA
- Kwa taarifa
- Katibu tarafa  
S.L.P 6  
IGURUBI
- Kwa taarifa

SURVEY OF PLOT No ... ..BLOCK... .. AT IGULUBI  
IGUNGA DISTRICT - TABORA

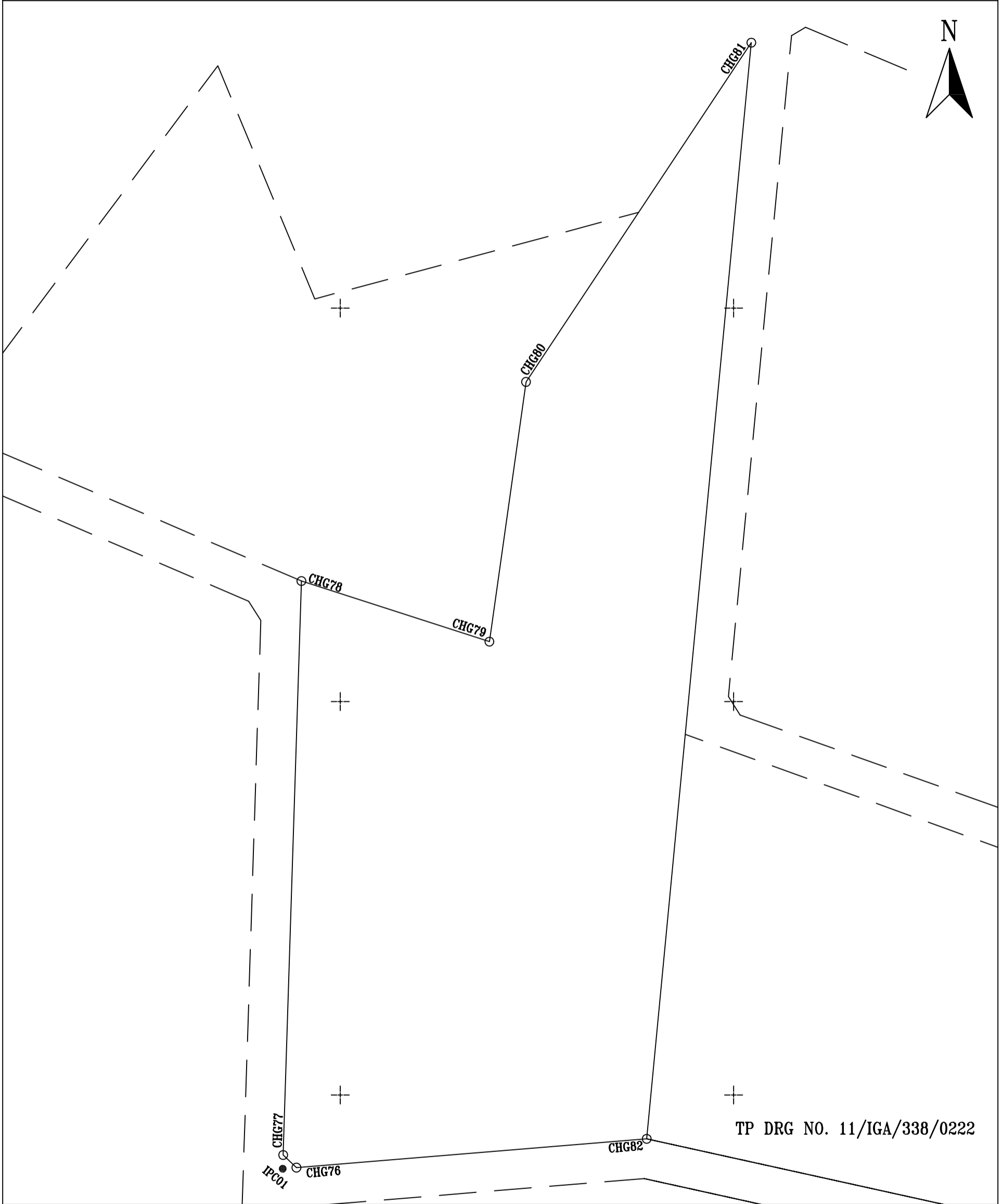

TP DRG NO. 11/IGA/338/0222

<p><b>RECORDS OFFICE REFERENCE;</b></p> <p>Comps No. ....</p> <p>M. P No. ....</p> <p>Sheet No ....</p> <p>Action CC ....</p> <p>PLAN No. _____</p>	<p style="text-align: center;">SCALE 1:2000</p> <p>Amendments made by:</p> <p>1.....</p> <p>2.....</p> <p>3.....</p> <p>Photostat copies sent to:</p> <p>1.....</p> <p>2.....</p> <p>3.....</p>	<p style="text-align: center;">Plan drawn by Joshua Jahula</p> <p>I hereby certify that the survey represented by this plan was carried out in accordance with the survey regulations.</p> <p style="text-align: right;">Date.....</p> <p style="text-align: right;">DICKSON WASHOKELA REGIONAL LAND SURVEYOR - TABORA REGISTERED PLAN No _____</p>
---	---	---

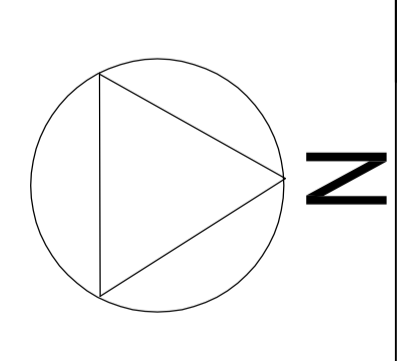

**LEGEND**

- SUBJECT AREA
- EXISTING BUILDINGS
- RESIDENTIAL PLOTS
- COMMERCIAL/RESIDENTIAL
- SPECIAL INDUSTRIAL
- DISPENSARY
- OPEN SPACE
- MARKET
- NURSERY SCHOOL
- RELIGIOUS SITE

**LAND USE DISTRIBUTION**

LAND USE	NO. OF PLOTS	AREA (Ha)
RESIDENTIAL	176	1.88
COMMERCIAL/RESIDENTIAL	77	1.45
SPECIAL INDUSTRIAL	10	10.9
MARKET	1	5.75
LORRY PARKING	1	5.75
DISPENSARY	1	5.75
NURSERY SCHOOL	1	5.75
OPEN SPACE	2	5.75
RELIGIOUS SITE	1	5.75
WASTE COLLECTION POND	1	4.2
<b>TOTAL</b>	<b>271</b>	<b>23.98</b>

**ADJOINT T.P. DRAWING**

NIL	NIL	NIL
NIL	11/IG/94/032023	NIL
NIL	NIL	NIL

**BASE MAP**

SATELLITE IMAGES 2022

STANDARD SHEET 1:2500 (1992)

FIELD SURVEY, JANUARY, 2023

**PREPARED BY**

DISTRICT PLANNING OFFICE - IGUNGA

**ACCEPTED BY**

DATE

URBAN PLANNING COMMITTEE

SCALE 1:2500

NO.	REVISION	DATE

TP DRG NO. 11/IG/94/032023

**IGUNGA DISTRICT COUNCIL**

**IGULUBI SPECIAL INDUSTRIAL LAYOUT PLAN**

MINISTRY OF LANDS, HOUSING AND HUMAN SETTLEMENTS DEVELOPMENT - PHYSICAL PLANNING DIVISION

**APPROVED BY:**

(Name) ..... (Signature) ..... (Date) .....

REGIONAL TOWN PLANNER  
TABORA REGION

TP DRG NO. 11/IG/94/032023

**DESIGNED & DRAWN BY:**

TP.BENEDICT MILEWA 0464 - T0320 .....

**CHECKED BY:**

NAME ..... REG. NO. SIGNATURE DATE

CHECKED BY: ..... REG. NO. SIGNATURE DATE