

THE UNITED REPUBLIC OF TANZANIA  
MINISTRY OF MINERALS  
MINING COMMISSION



THE MINING (MINERAL RIGHTS) REGULATIONS, 2018  
PRIMARY MINING LICENCE PML0013SMN

*The Mining Act, Cap. 123*

The exclusive right, subject to the provisions of *The Mining Act, Cap. 123* and the regulations made thereunder or which may come into force during the continuance of this primary mining licence or any renewal thereof is hereby granted to M/S **GodMwanga Gems Limited of P.O Box 8004, Arusha, Tanzania** (hereinafter called the Licensee), to prospect and mine for **Graphite**, at **Endiamtu**, in **Simanjiro** District, QDS 71/2 over an area described in Annex A.

This Licence, unless sooner cancelled, suspended or surrendered pursuant to the provisions of *The Mining Act, Cap. 123* shall be valid for a period of **seven (7)** years, effective from the date of grant.

Granted this **24<sup>th</sup>** day of **MAY** 2019

*Daudi Ntalima*

*Daudi Ntalima*  
For: EXECUTIVE SECRETARY

**ANNEX A**

**DESCRIPTION OF THE PRIMARY MINING LICENCE AREA**

The Primary Mining Licence is at **Endiamtu** area in **Simanjiro** District, QDS 71/2 defined by the following corner co-ordinates (Arc 1960):

Corner	Latitude	Longitude
1	- 03 deg. 37 min. 5.15 sec.	36 deg. 59 min. 27.75 sec.
2	- 03 deg. 37 min. 9.81 sec.	36 deg. 59 min. 33.26 sec.
3	- 03 deg. 37 min. 17.01 sec.	36 deg. 59 min. 27.61 sec.
4	- 03 deg. 37 min. 12.65 sec.	36 deg. 59 min. 22.05 sec.

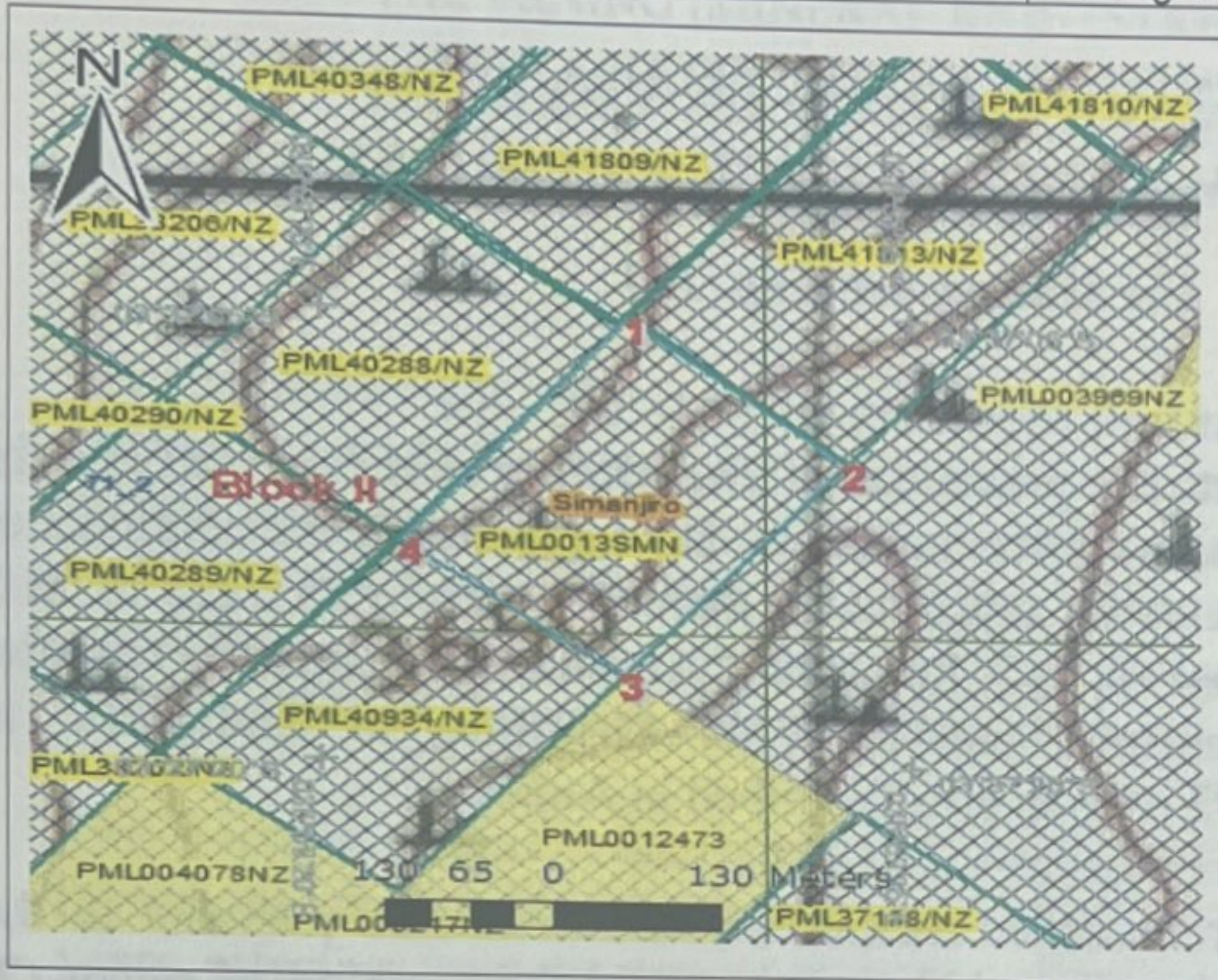

Legend	
Licensed area	
License Number	<b>PML0013SMN</b>
District	Simanjiro
Direction	

An area of approximately **6.28** Hectares.

**ANNUAL RENT PAYMENTS**

Year	ERV	Amount (TShs.)	Date	Signature & Stamp	
2019	1. 2020	25320138	288805/-	28/5/2019	
2020	2. 2021	922090100926273	282600/-	31/04/2022	
2021	3. 2022	922090100926273	282600/-	31/04/2022	
4.					
5.					
6.					
7.					

**THE UNITED REPUBLIC OF TANZANIA**  
**MINISTRY OF MINERALS**  
**MINING COMMISSION**



**THE MINING (MINERAL RIGHTS) REGULATIONS, 2018**  
**PRIMARY MINING LICENCE PML0014SMN**

*The Mining Act, Cap. 123*

The exclusive right, subject to the provisions of *The Mining Act, Cap. 123* and the regulations made thereunder or which may come into force during the continuance of this primary mining licence or any renewal thereof is hereby granted to M/S **GodMwanga Gems Limited** of P.O Box 8004, Arusha, Tanzania (hereinafter called the Licensee), to prospect and mine for **Graphite** at **Endiamtu** in **Simanjiro** District, QDS 71/2 over an area described in Annex A.

This Licence, unless sooner cancelled, suspended or surrendered pursuant to the provisions of *The Mining Act, Cap. 123* shall be valid for a period of **seven (7)** years, effective from the date of grant.

Granted this **24<sup>th</sup>** day of **MAY** 2019

**†549459**

*Daudi Ntalima*

**For: EXECUTIVE SECRETARY**

ANNEX A

DESCRIPTION OF THE PRIMARY MINING LICENCE AREA

The Primary Mining Licence is at **Endiamtu** area in **Simanjiro** District, QDS 71/2 defined by the following corner co-ordinates (Arc 1960):

Corner	Latitude	Longitude
1	- 03 deg. 37 min. 12.65 sec.	36 deg. 59 min. 22.05 sec.
2	- 03 deg. 37 min. 17.01 sec.	36 deg. 59 min. 27.61 sec.
3	- 03 deg. 37 min. 24.25 sec.	36 deg. 59 min. 21.84 sec.
4	- 03 deg. 37 min. 19.87 sec.	36 deg. 59 min. 15.91 sec.

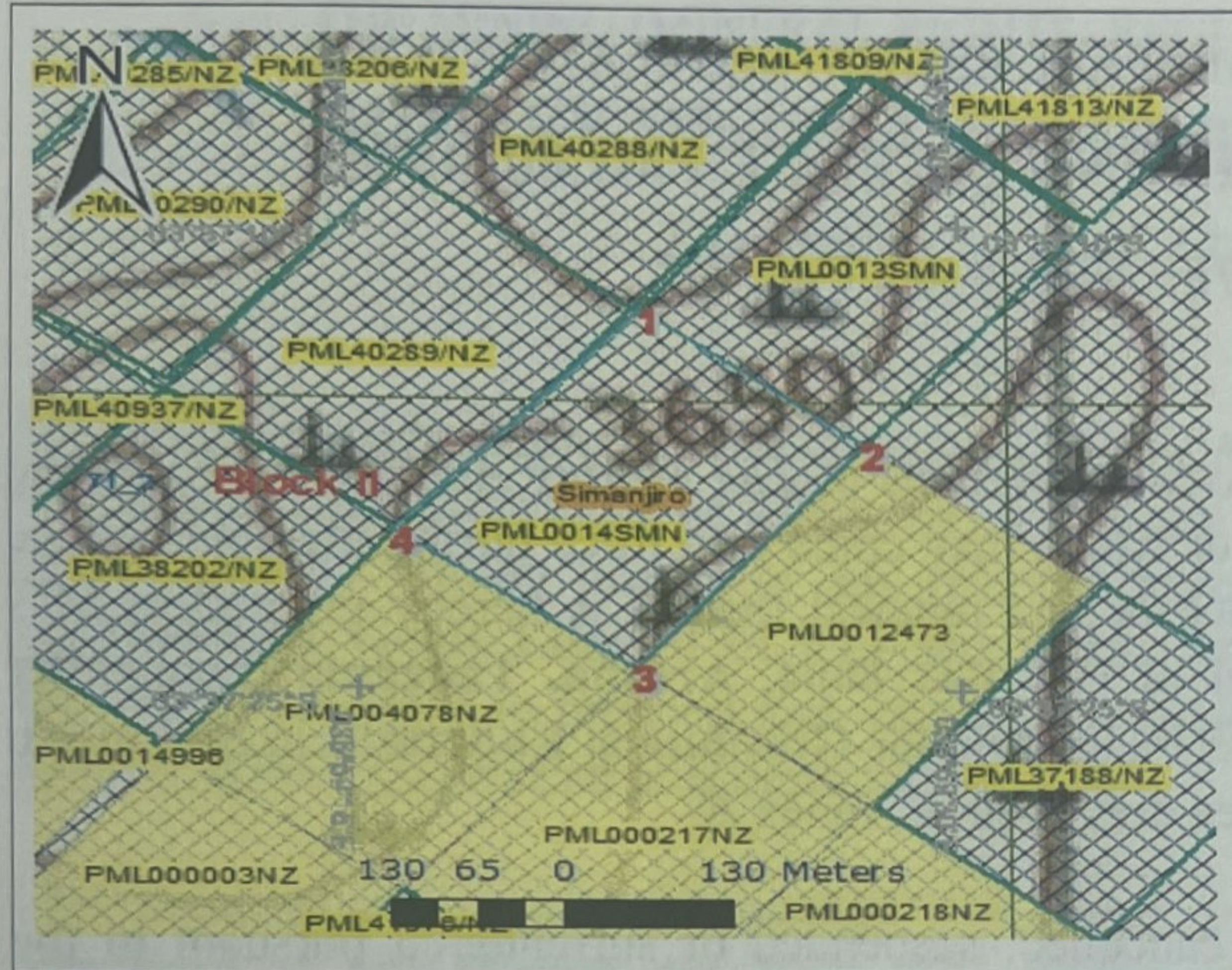

Legend	
Licensed area	
License Number	<b>PML0014SMN</b>
District	Simanjiro
Direction	

An area of approximately **6.41** Hectares.

ANNUAL RENT PAYMENTS

Year	ERV	Amount (TShs.)	Date	Signature & Stamp	
2019 <sup>1</sup>	2020	25320139	294784	28/5/2019	
2020 <sup>2</sup>	2021	922090100926273	288450	31/04/2022	
2021 <sup>3</sup>	2022	922090100926273	288450	31/04/2022	
4.					
5.					
6.					
7.					