

# HIMO URBAN AREA

INSET SHOWING DETAILS OF PLOT

LOCALITY HIMO

BLOCK E

PLOT NO. 209

L.O. NO. 385786

AREA 800 Sq. m.

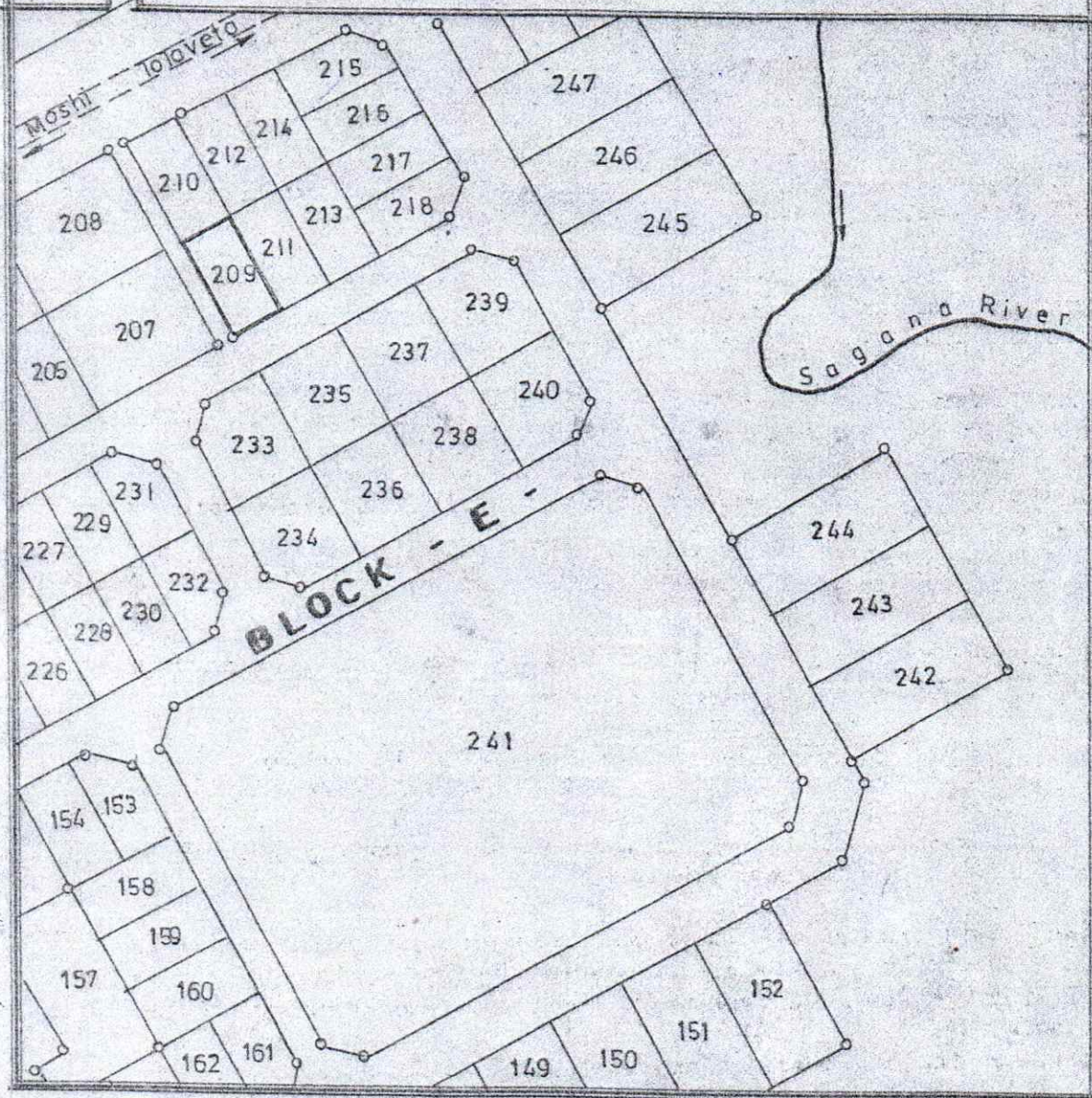
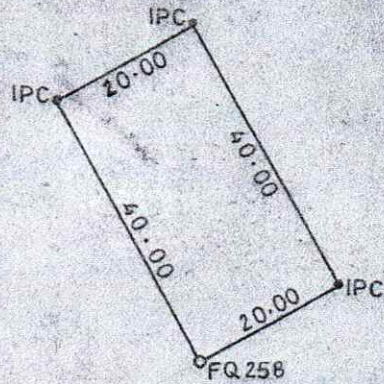

This Issue of this plan implies no guarantee or admission of title by the Government

This plan, prepared in accordance with registered Plan No. 29479 is approved for the purpose of the Land Registration Ordinance  
Director of Surveys and Mapping *[Signature]* Date 8/12/2010  
Ministry of Lands and Human Settlements Development.