

SURVEY OF FARM No **1759** AT LUBUNGO
MVOMERO DISTRICT - MOROGORO REGION

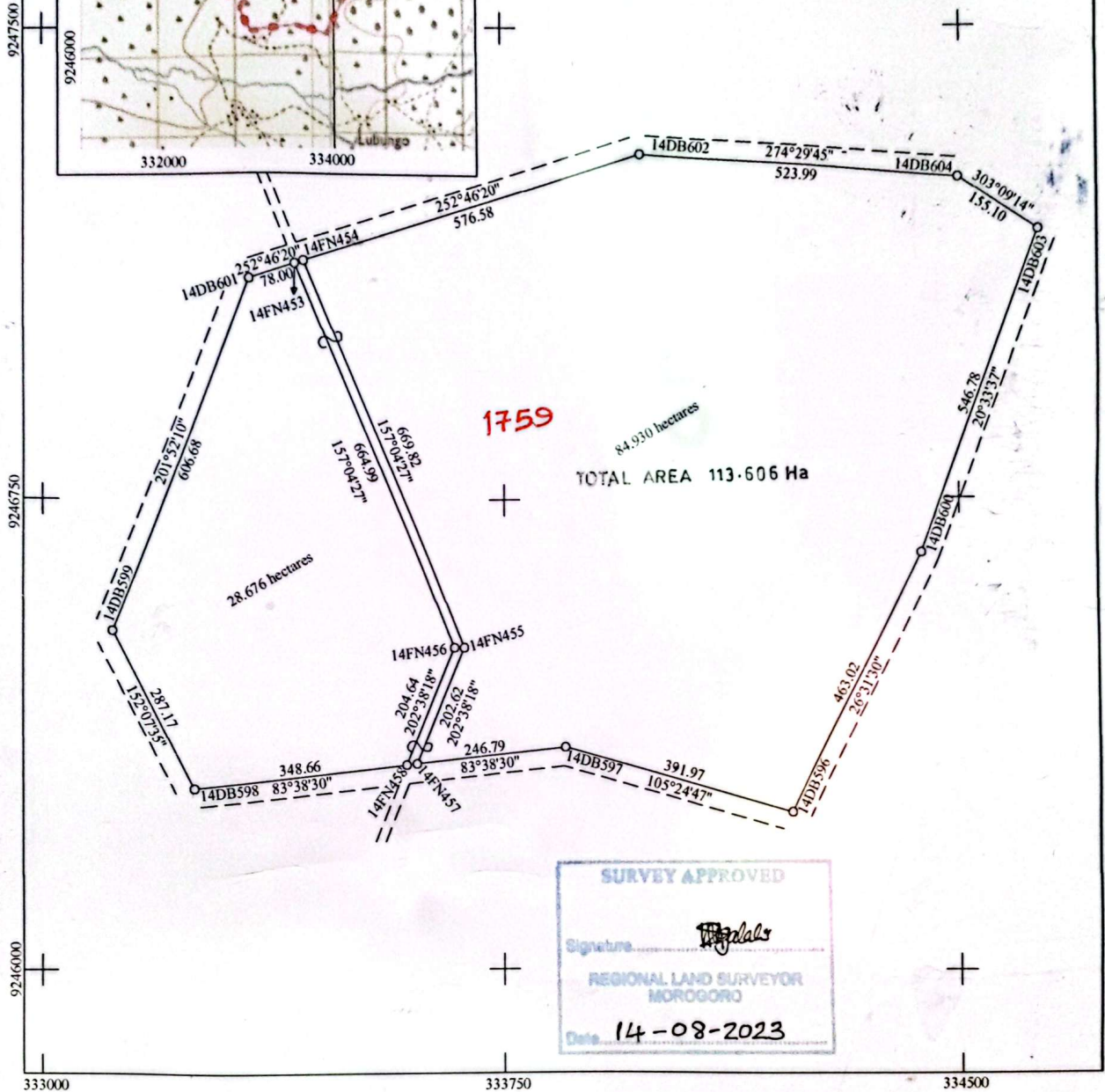
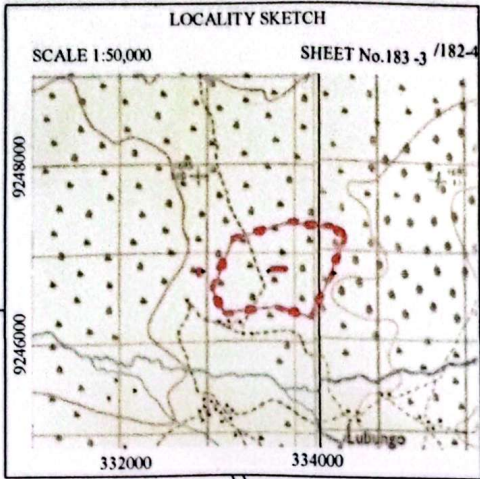

COMPS **E" 339^B**
 MP **182/IV/2**
 STD SHEET **182/IV**
 ACTION CC
 PLAN No **E" 339/95**

AMENDMENTS MADE BY:-
1 KYOMO N. (FARM No.) 31.05.2023
 2
 3
 PHOTOSTAT COPIES SENT TO-
 1
 2
 3

Plan Drawn by Emmanuel Natulu
 I hereby certify that the survey represented by this plan was carried out in accordance with the survey regulations.

Bernard B. Maluga
 LICENSED LAND SURVEYOR
 Integrated Property Consultancy and Services (IPCS) Company Limited.
 Date **20/03/2023**
 Registered Plan No. **182941**