

SUKI FOOD COMPANY LIMITED
P.o Box 25500 Dar es Salaam
Dealing with manufacturing of Milk Powder and Candies

11th February 2025

Executive Director,
Tanzania Investment Centre,
P.o Box 938,
Dar es Salaam.

Dear Sir/Madam

**REF: REQUEST FOR AMENDMENT OF CERTIFICATE OF INCENTIVES NO.
2024112331 TO REFLECT CURRENT LOCATION**

Refer to the heading above.

We the designated body of directors of **SUKI FOOD COMPANY LIMITED**, we applied in your esteemed office for registration of incentive certificate and being successfully registered & issued certificate of incentive No. 2024112331 dated 15th November 2024. During registration, we submitted a copy of the lease agreement without clear details on the project location but we have successful managed to purchase that area which has been surveyed to *Plot No. 1 Block 18C, Kwazoka Village, Chalinze District Council – Pwani.*

As our company has relocated to a new address, we kindly request your esteemed office to amend the said certificate to reflect our current location. This amendment is necessary for us to acquire a title deed under our company's name.

We have attached the relevant documents, including proof of the new address i.e. copy of survey map and the original certificate, for your reference.

We appreciate your prompt attention to this matter and look forward to your favorable response. Should you require any additional information or documentation, please do not hesitate to contact us.

Thank you for your cooperation.

Yours sincerely

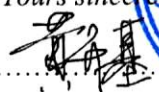
.....
Huang Kaiji (DIRECTOR)





CHALINZE DISTRICT COUNCIL LAND OFFICE
P.O BOX 65 CHALINZE, PWANI
TEL: +255232935403
E-MAIL: chalinzedc@chalinze.go.tz



THE UNITED REPUBLIC OF TANZANIA
MINISTRY OF LANDS, HOUSING
AND HUMAN SETTLEMENTS
DEVELOPMENT

SURVEY PLAN

SURVEY OF PLOTS NO 1 BLOCK " 18C " AT KWAZOKA, CHALINZE DISTRICT COUNCIL, PWANI

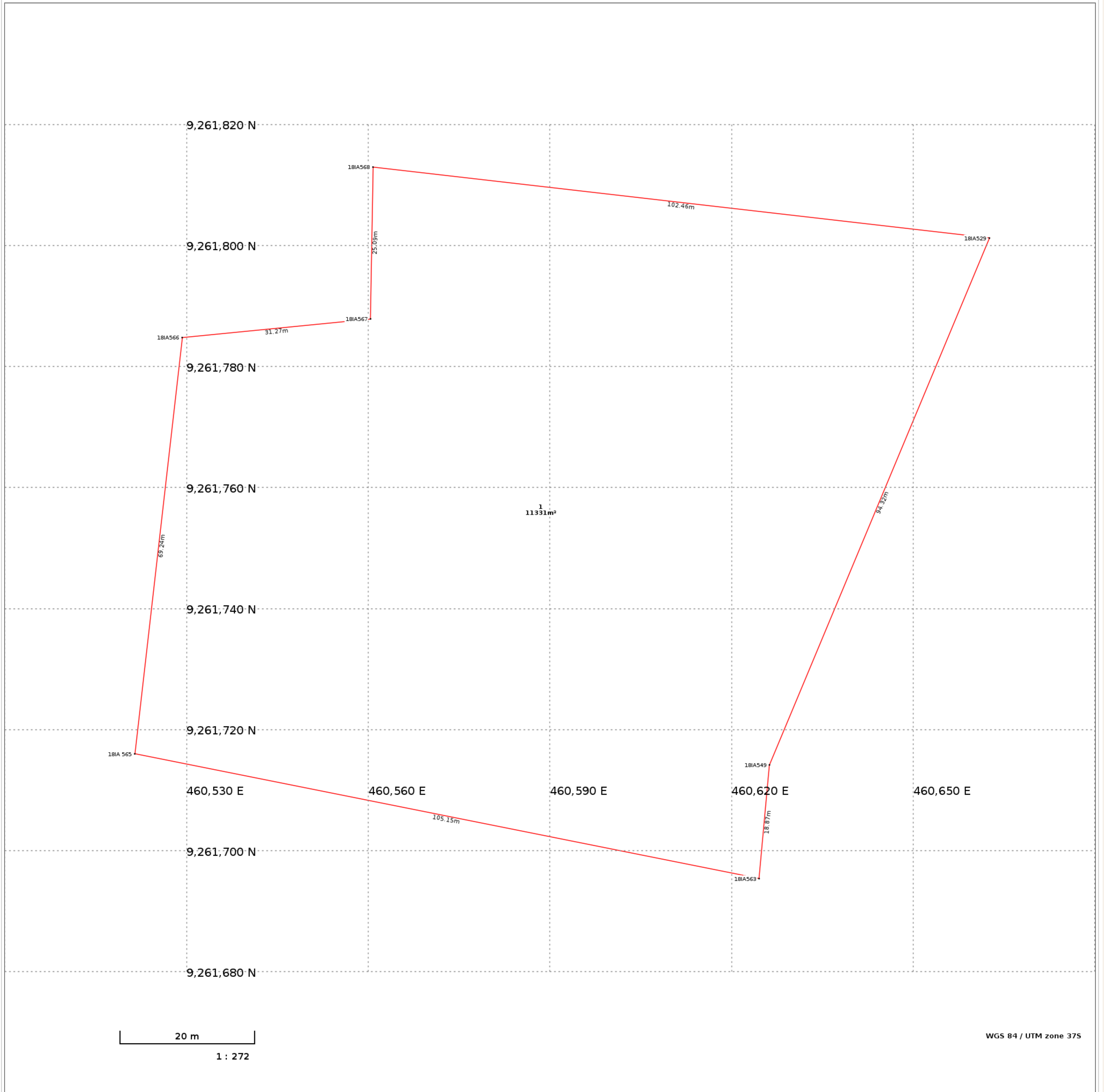

Reg. Plan No: NA
 Survey Inst. No: CHLSI00000318
 TP No: PWA/02/408/2024



Plan generated from parcels approved on the 19 day of December 2024 by Cletus Athanas Antony , Regional Land Surveyor. I hereby certify that the survey represented by this plan was carried out in accordance with the survey regulations.



Cletus Athanas Antony
 Regional Land Surveyor