

TANZANIA

Land Form 51

CERTIFICATE OF OCCUPANCY

(Issued under Section 9 of the Land Ordinance)

Date of Issue:

Title Number: 15492 LAND REGISTRY - MOSHI

Land Office Number: 158405

Land: Farm No. 137 (part of) Situated at Arusha Chini Moshi District.

Term: ninety nine (99) years.



Ref. No: LR/MS/7/15492/2
To: T.P.C LIMITED
P.O. Box 93, MASHI.

Date: 14th Sept - 2000

Sir/Gentleman/Madam,

RE: THE LAND REGISTRATION ORDINANCE (CAP. 334)

TITLE NO: 15492 ... L.O. NO: 158405 ... FIRM NO: 137 (Part of)
BLOCK NO: 94 ARUSHA CHINI, MASHI DISTRICT.

I have the honour to enclose herewith the duplicate of Certificate Title numbered as above.

Please endorse your signature on the enclosed form of receipt and return the same to me in due course.

I am, Sir/Gentleman/Madam
Your Obedient Servant.

PRINCIPAL ASSISTANT REGISTRAR OF TITLES
MUSILI.

J. J. Meya

DISTRICT
The Registrar Land Office,
P.O. Box 97
KILIMANJARO/ARUSHA/TANZANIA.

Date of c.o. 27-7-2000

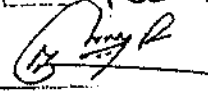
TITLE No 1544 d
 REGISTERED ON
 14-9-2000
 at 900 am.

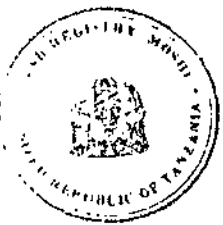
 Asst. Registrar of Titles

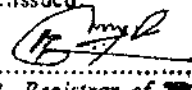

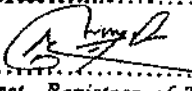
Stamp Duty Shs. 100/= Paid
 on Original Revenue Receipt No. 09326406
 of 19-11-99 issued
 LD. NO. 13354/9

 Asst. Registrar of Titles

Stamp Duty Shs. 30500/= Paid
 on Original Revenue Receipt No. 09326406
 of 19-11-99

 Asst. Registrar of Titles

THE UNITED REPUBLIC OF TANZANIA
 The Land Ordinance (Section 9 (ii))

CERTIFICATE OF OCCUPANCY

The 27th

day of July Two thousand

TITLE NO: 1544 d LAND REGISTRY - MOSHI

THIS IS TO CERTIFY that: T.P.C. LIMITED a limited liability Company having its registered office at P.O. Box 93, Moshi (hereinafter called "the Occupier") is entitled to a Right of Occupancy (hereinafter called "the Right") in and over the land described in the Schedule here-to (hereinafter called "the Land") for a term of ninety nine years from the first day of July One thousand nine hundred and ninety nine according to the true intent and meaning of the Land Ordinance and to any enactment in substitution therefor or amendment thereof and to the following special conditions:-

1. The occupier having paid rent up to the thirtieth day of June, 2000 shall thereafter pay rent of six hundred and ten thousand (Shs. 610,000/=) a year in advance on the first day of July in every year of the term without any deduction PROVIDED that the rent may be revised by the Minister for the time being responsible for Lands (hereinafter called "the Minister") on the first day of July in each of the years 2009, 2019, 2029, 2039, 2049, 2059, 2069, 2079 and 2089 or within three years thereafter in each case.

2. The land shall be used for Agricultural purposes. Use Group "A" use class (a) as defined in the Town and Country Planning (use classes) Regulations 1960 as amended in 1993.

3. The Occupier shall:-

- (a) demarcate the boundaries of the land to the satisfaction of Moshi District Council (hereinafter called "the Authority") and thereafter so maintain such demarcation that the boundaries

SCHEDULE

ALL that land known as farm Number 137 (part of) situated at Arusha Chini Mushi District containing one thousand and five (1005) acres shown for identification only edged red on the plan attached to this Certificate and delineated on the registered survey plan numbered 2367 deposited at the Office of the Director of Surveys and Mapping at Dar es Salaam.

GIVEN under my hand and seal and by Order of the Minister the day and year first above written.

[Handwritten Signature]
COMMISSIONER FOR LANDS

We, the within-named T.P.C. LIMITED hereby accept the terms and conditions contained in the foregoing Certificate of Occupancy.

SEALED with the COMMON SEAL of the said)
T.P.C. LIMITED and DELIVERED in the)
presence of us this.....day of.....))
.....2000.)

Signature: *[Handwritten Signature]*)
Postal Address: TPC LIMITED Box 93 MUSHI.)
Qualification: GENERAL MANAGER.)
Signature: *[Handwritten Signature]*)
Postal Address: *[Handwritten Address]*)
Qualification: *[Handwritten Qualification]*)





MOSHI DISTRICT

INSET SHOWING DETAILS OF FARM
 LOCALITY ARUSHA CHINI
 BLOCK _____
 FARM NO. 137 (Part of)
 L.O. NO. 158405
 AREA 1005 ACRES

This listing of the plan implies no guarantee
 or admission of title by the Government

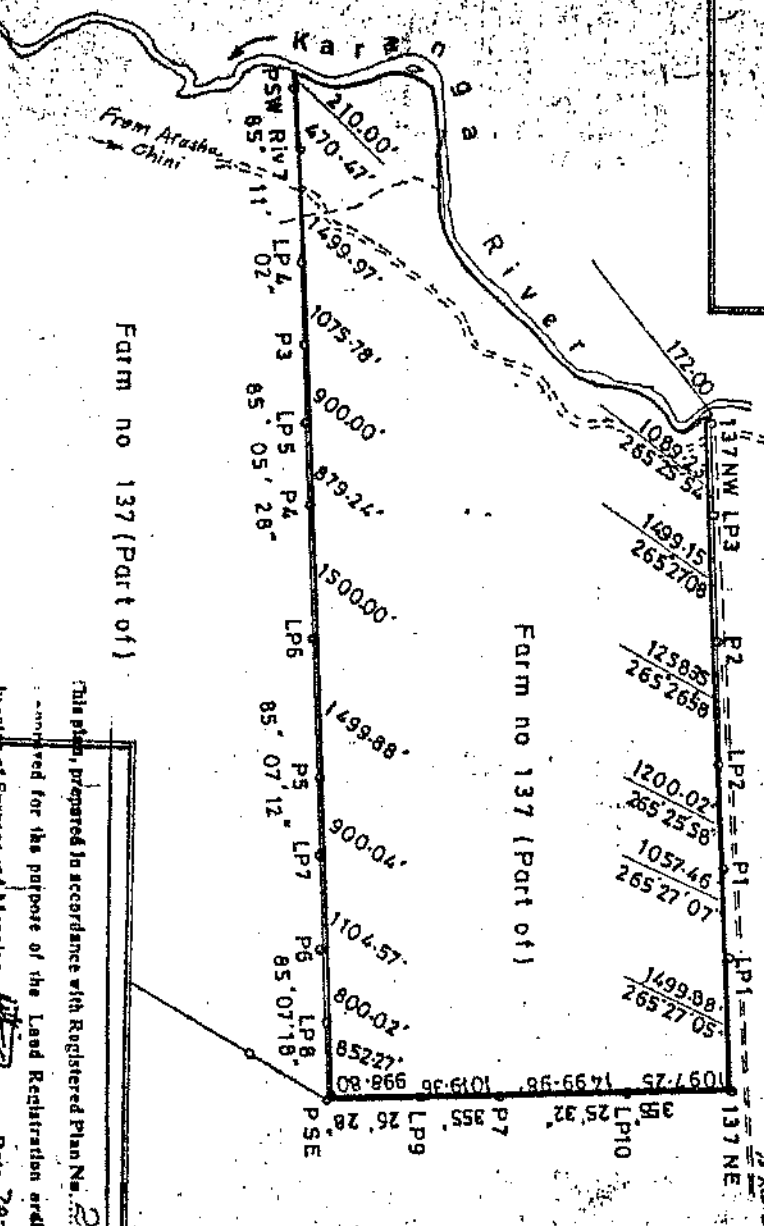

Farm no 137 (Part of)

Farm no 137 (Part of)

Farm no 136 (Part of)

This plan, prepared in accordance with Registered Plan No. 2367
 approved for the purpose of the Land Registration Ordinance
 of Surveys and Mapping, Date: 20-01-2000
 of Lands, Housing and Urban Development

(

(