

(15)



CERTIFICATE OF TITLE TO LEASEHOLD LAND

This is to certify that the annexed copy of Certificate of Occupancy dated the Thirteenth day of July, 1969 is registered in the Land Registry under Title No. 18655. Copies of the subsisting entries in the register are within.

Dated the Sixth day of November 1971

I hereby state this is the true photostat copy of the original one

Asst. Registrar of Titles MOSHI

Title No. 18655. Description of registered land. ALL THAT piece or parcel of land situated East of the Weru-Weru River and about One Mile South of the Sanya Branch Railway in the District of Moshi as delineated and edged red on the Survey Department Plan No. E 5 26/1819 Marked "A" and annexed to Filed Document No. 58337 being part of the Right of Occupancy registered under Certificate of Title No. 1184 a copy of which is enclosed hereto.



58337

11.9.71

Transfer to THE TANGANYIKA PLANTING COMPANY LIMITED of P.O. Box 93, Moshi.

(Consideration Shs.980,000/= including other titles).

LAND REGISTRY, MOSHI  
MORTGAGE

Filed Document No. **5523**  
**DISCHARGED**  
Date of registration **12-10-80** time **8:00 A.M.**  
To **EAST AFRICAN DEVELOPMENT BANK**  
to secure various foreign currencies equivalent to SDR 1,853,000 (including C.T. Nos. 1189, 1188, 833, 821, 1442 NR/2, 10624, 18656, 14669 + 832)

*[Signature]*  
Asst. Registrar of Titles

LAND REGISTRY, MOSHI  
CHANGE OF NAME - F.D. 58337  
Filed Document No. **12928**  
Date of registration **4-9-2000** time **8:30 A.M.**  
To **TDC Limited of P.O. Box 93, Moshi.**  
*[Signature]*  
Asst. Registrar of Titles

LAND REGISTRY, MOSHI  
MORTGAGE

Filed Document No. **7081**  
**DISCHARGED**  
Date of registration **10-10-1990** time **9:00 A.M.**  
To **THE NATIONAL BANK OF TANZANIA**  
P.D. No. 12174 on **7-10-99** at **11:00 am.**  
1442, 14681, NR/2, 10624, 1188, 1189 and 833

*[Signature]*  
Asst. Registrar of Titles

LAND REGISTRY, MOSHI  
MORTGAGE **DISCHARGED**  
Filed Document No. **12018**  
Date of registration **5-10-2000** time **9:00 am**  
To **CRDB BANK LIMITED**  
to secure TMS 1500 000/= including C.T. Nos. 833, 1184, 1188, 1189, 1442, 10624, 1449, 18656 + NR/2  
*[Signature]*  
Asst. Registrar of Titles

LAND REGISTRY, MOSHI  
CHANGE OF NAME - F.D. 7081

Filed Document No. **12008**  
**DISCHARGED**  
Date of registration **27-8-99** time **9:00 A.M.**  
To **NRC (1997) LIMITED**  
P.O. Box **1863**  
at **11:00 am**  
**DAR-ES-SALAAM.**

*[Signature]*  
Asst. Registrar of Titles







SCHEDULE.

that piece or parcel of land situated East of the Wer-Weru  
and about One mile South of the Sanya Branch Railway  
District of Moshi containing approximately One thousand  
and Four (1,804) acres as delineated and edged  
on the plan annexed hereto.



Given under my hand and the Public Seal of the Territory of Idaho  
this 10th day of June 1890.

*John W. Shoshone*  
Governor

I do hereby certify that the within named *Billie M. Johnson* has been  
admitted and conditions contained in the foregoing Certificate of

Witnessed



65' ROAD RESERVE  
105' 44" 24' 263'

3  
No 1864 (Part of)  
a 197 Acres

LAND TO BE TRANSFERRED TO TANGANYIKA  
PLANTING COMPANY LTD NETT AREA  
4550 ACRES

10/11/67  
TANGANYIKA  
12/11/67

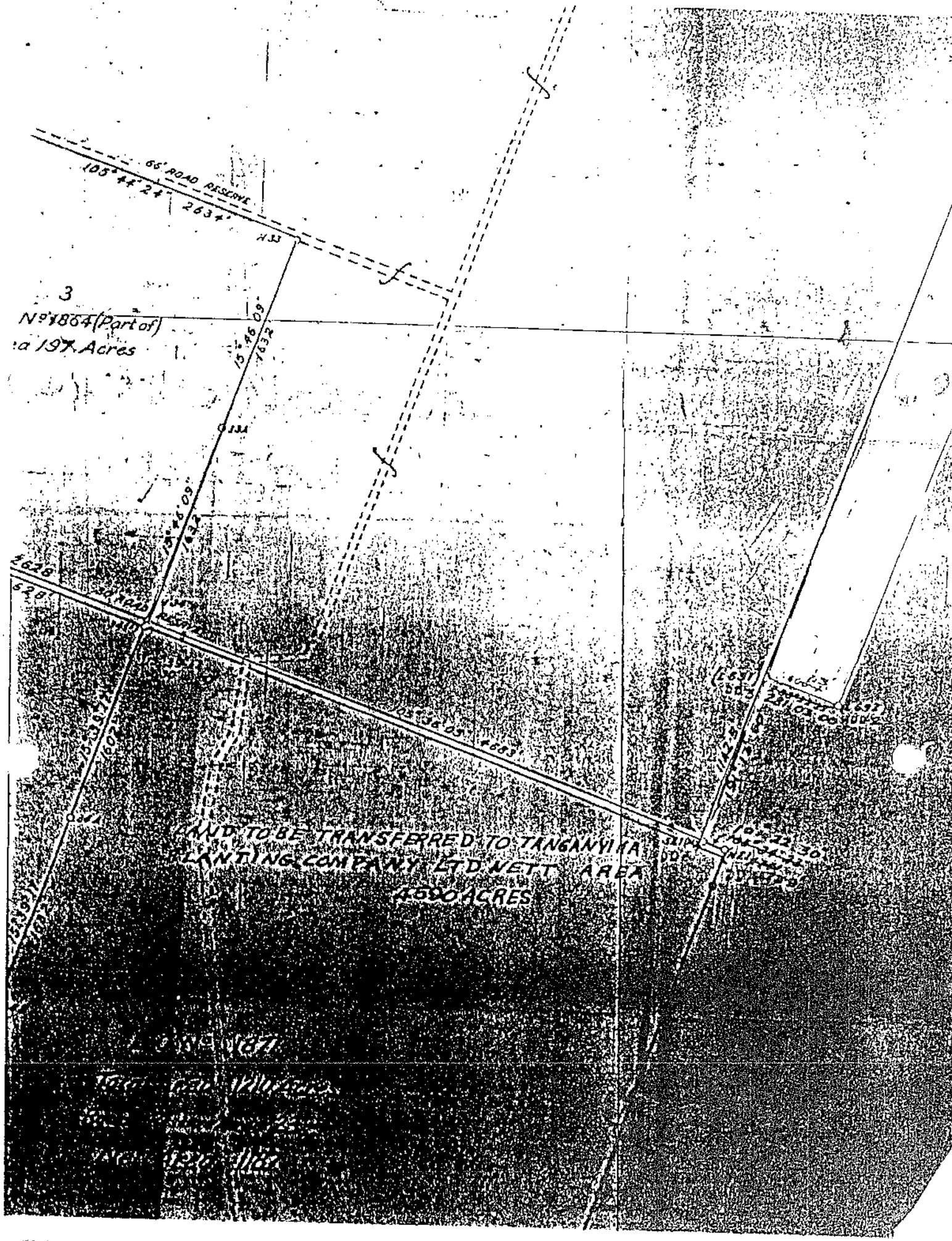



ARUSHA CHINI

MOSHI DISTRICT

E. of No. 13570

Total Area 1228 Acres

Road Reserve Area 24 "

Net Area 1204 "

66 ROAD RESERVE

66 ROAD RESERVE

