

TC CEMENT COMPANY LIMITED

Date:23/12/2025

The Director General
Tanzania Investment and Special Economic Zones Authority (TISEZA) Dar
es Salaam, Tanzania

Subject: Application for Change of Factory Location to Morogoro Region – Limestone Mining License No. PL 13541/2025

Dear Sir,

We refer to our approved investment/project details previously submitted to the Tanzania Investment and Special Economic Zones Authority.

We hereby wish to formally notify your office and apply for approval to **change the location of our proposed factory to Morogoro Region**, in close proximity to large limestone deposits covered under **Mining License No. PL 13541/2025**.

The decision to relocate the factory has been made after detailed technical and economic assessment, and is intended to:

- Align the manufacturing facility with the source of the primary raw material (limestone);
- Reduce logistics and transportation costs;
- Improve production efficiency and long-term operational sustainability.

The Board of Directors has duly approved this change, and a Board Resolution is attached for your reference. All other project parameters remain unchanged unless otherwise communicated.

We respectfully request TISEZA's guidance and approval to update our project records accordingly.

Please find attached:

1. Board Resolution approving the change of factory location
2. Copy of Limestone Mining License (PL No. 13541/2025)

We remain at your disposal for any further information or clarification and look forward to your continued support.

Yours faithfully,

**For and on behalf of
TC Company Limited**

ZHU JIN FENG

Signature:

A handwritten signature in black ink, appearing to be 'ZHU JIN FENG', written over a faint rectangular stamp.

Title: Director

THE UNITED REPUBLIC OF TANZANIA
MINISTRY OF MINERALS
MINING COMMISSION

PROSPECTING LICENCE NO. PL 13541/2025

GRANTED PURSUANT TO SECTION 42 OF THE MINING ACT, CAP. 123

WHEREAS M/S Zhu Jin Feng of P. O. Box 42450, Dar es Salaam, Tanzania has fulfilled the conditions for grant of Prospecting Licence pursuant to Section 41 of *The Mining Act, Cap. 123*;

I, Eng. Ramadhani M. Lwamo, **EXECUTIVE SECRETARY**, subject to the provisions of *The Mining Act, Cap. 123* and of the regulations made thereunder or which may come into force during the continuance of this Licence, or any renewal thereof and pursuant to the powers conferred upon me under Section 42 of *The Mining Act, Cap. 123* hereby grant to M/S Zhu Jin Feng (hereinafter called the Licensee) a **Prospecting Licence - Industrial Minerals**, to prospect for **Limestone**, in **Morogoro** District, over an area described in Annex A (hereinafter called the Licence Area), conferring on the Licensee the right to carry on such prospecting operations, abide to Annex B, Annex C and Annex D and execute such other works as are necessary for that purpose.

This Licence, unless sooner cancelled, suspended or surrendered pursuant to the provisions of *The Mining Act, Cap. 123* shall be valid for a period of **forty eight (48)** months, effective from the date of grant.

Granted this 19th day of September 2025

Eng. Ramadhani M. Lwamo
EXECUTIVE SECRETARY

INITIAL PERIOD

From Date	To Date	Prep. Fee and Rent	ERV Number	Date	Signature of ES
		USD 300.00	925098322923385	08/04/2025	<i>[Signature]</i>
19/09/2025	18/09/2026	USD 3,750.30	925098322923385	08/04/2025	<i>[Signature]</i>

FOR: EXECUTIVE SECRETARY
MINING COMMISSION

FIRST RENEWAL

I HEREBY CONSENT TO THE FIRST RENEWAL OF PROSPECTING LICENCE NO. of M/S of P. O. Box for Licence Area described in Annex 'A' and conditions prescribed in Annex 'B', 'C' and Annex 'D' for a period of months effective from the day of year

EXECUTIVE SECRETARY

From Date	To Date	Annual Rent	ERV Number	Date	Signature of ES

SECOND RENEWAL

I HEREBY CONSENT TO THE SECOND RENEWAL OF PROSPECTING LICENCE NO. of M/S of P.O. Box for Licence Area described in Annex 'A' and conditions prescribed in Annex 'B', 'C' Annex 'D' for a period of months effective from the day of year

.....
EXECUTIVE SECRETARY

From Date	To Date	Annual Rent	ERV Number	Date	Signature of ES

[Handwritten mark]

ANNEX A

DESCRIPTION OF THE LICENCE AREA

Subject to Section 120 of the Mining Act, Cap. 123 the Licence is in Morogoro District, QDS 202/1 defined by lines of latitude and longitude having the following corner coordinates (Arc 1960):

Corner	Latitude	Longitude
1	- 07 deg. 14 min. 27.89 sec.	38 deg. 09 min. 59.72 sec.
2	- 07 deg. 10 min. 39.46 sec.	38 deg. 09 min. 59.65 sec.
3	- 07 deg. 11 min. 20.06 sec.	38 deg. 10 min. 24.32 sec.
4	- 07 deg. 11 min. 30.04 sec.	38 deg. 10 min. 24.43 sec.
5	- 07 deg. 11 min. 30.06 sec.	38 deg. 10 min. 35.08 sec.
6	- 07 deg. 11 min. 19.83 sec.	38 deg. 10 min. 35.13 sec.
7	- 07 deg. 11 min. 19.92 sec.	38 deg. 10 min. 24.51 sec.
8	- 07 deg. 10 min. 38.97 sec.	38 deg. 10 min. 0.12 sec.
9	- 07 deg. 09 min. 38.39 sec.	38 deg. 12 min. 41.43 sec.
10	- 07 deg. 09 min. 47.71 sec.	38 deg. 13 min. 12.80 sec.
11	- 07 deg. 11 min. 0.22 sec.	38 deg. 12 min. 54.92 sec.
12	- 07 deg. 11 min. 26.66 sec.	38 deg. 13 min. 57.29 sec.
13	- 07 deg. 11 min. 59.85 sec.	38 deg. 14 min. 2.49 sec.
14	- 07 deg. 11 min. 59.93 sec.	38 deg. 13 min. 54.28 sec.
15	- 07 deg. 12 min. 6.97 sec.	38 deg. 13 min. 55.92 sec.
16	- 07 deg. 12 min. 6.44 sec.	38 deg. 13 min. 6.41 sec.
17	- 07 deg. 13 min. 4.33 sec.	38 deg. 11 min. 49.51 sec.
18	- 07 deg. 13 min. 0.43 sec.	38 deg. 11 min. 44.15 sec.
19	- 07 deg. 12 min. 53.57 sec.	38 deg. 11 min. 46.08 sec.
20	- 07 deg. 12 min. 46.51 sec.	38 deg. 11 min. 59.22 sec.
21	- 07 deg. 12 min. 38.00 sec.	38 deg. 12 min. 13.44 sec.
22	- 07 deg. 12 min. 32.61 sec.	38 deg. 12 min. 10.07 sec.
23	- 07 deg. 12 min. 29.50 sec.	38 deg. 12 min. 23.72 sec.
24	- 07 deg. 12 min. 21.14 sec.	38 deg. 12 min. 22.89 sec.
25	- 07 deg. 12 min. 25.57 sec.	38 deg. 12 min. 6.10 sec.
26	- 07 deg. 12 min. 20.31 sec.	38 deg. 12 min. 2.81 sec.
27	- 07 deg. 12 min. 34.64 sec.	38 deg. 11 min. 31.96 sec.
28	- 07 deg. 12 min. 41.54 sec.	38 deg. 11 min. 35.47 sec.
29	- 07 deg. 12 min. 55.32 sec.	38 deg. 11 min. 27.65 sec.
30	- 07 deg. 13 min. 0.67 sec.	38 deg. 11 min. 34.40 sec.
31	- 07 deg. 13 min. 12.89 sec.	38 deg. 11 min. 25.51 sec.
32	- 07 deg. 13 min. 18.95 sec.	38 deg. 11 min. 30.59 sec.

9



Legend	
Licensed boundary	
Licence Code	PL 13541/2025
District	Morogoro
Direction	

An area of approximately 34.71 Square Kilometres.

✍

ANNEX B

LOCAL CONTENT PLAN

1. The Licensee and their contractor, subcontractor, corporation or other allied entity carrying out mineral prospecting operations shall ensure that local content component is engaged in.
2. Subject to Clause 1 and to the requirement of any law relating to immigration, the Licensee, contractor and its sub-contractor(s) may bring into Tanzania such expatriate personnel as in the Licensee's judgement, required to carry out mineral prospecting operations efficiently and successfully and the Government shall expeditiously provide the necessary work permits and other approvals required for the employment of such expatriate.
3. A non-indigenous Tanzanian company which intends to provide goods or services to a licensee, contractor, subcontractor, corporation or other allied entity within Tanzania carrying out mining activities shall incorporate a joint venture company with an indigenous Tanzanian company and afford that the indigenous Tanzanian company has an equity participation of at least twenty (20%) per centum.
4. The Licensee, contractor, subcontractor, corporation or other allied entity shall procure goods and services (legal, insurance and financial) available in the United Republic of Tanzania in accordance with the approved procurement plan.
5. The Licensee shall on annual basis prepare a credible social responsibility plan jointly agreed by the relevant Local Government Authority or Local Government Authorities in consultation with the Minister responsible for Local Government Authorities and the Minister responsible for Finance.

*

ANNEX C

PROSPECTING PROGRAMME AND FINANCIAL EXPENDITURE ESTIMATE.

Subject to Section 40 of *The Mining Act, Cap. 123* and Regulation 9 of the Mining (Mineral Rights) Regulations, 2018, the Licensee shall expend on prospecting operations in respect of the licence granted as per submitted prospecting programme and financial expenditure estimates approved by the Mining Commission.

ANNEX D

INTEGRITY PLEDGE

The Licensee shall comply with the Statement of Integrity Pledge.

↑

THE UNITED REPUBLIC OF TANZANIA
MINISTRY OF MINERALS
MINING COMMISSION

PROSPECTING LICENCE NO. PL 13540/2025

GRANTED PURSUANT TO SECTION 42 OF THE MINING ACT, CAP. 123

WHEREAS M/S Zhu Jin Feng of P. O. Box 42450, Dar es Salaam, Tanzania has fulfilled the conditions for grant of Prospecting Licence pursuant to Section 41 of *The Mining Act, Cap. 123*;

I, Eng. Ramadhani M. Lwamo, **EXECUTIVE SECRETARY**, subject to the provisions of *The Mining Act, Cap. 123* and of the regulations made thereunder or which may come into force during the continuance of this Licence, or any renewal thereof and pursuant to the powers conferred upon me under Section 42 of *The Mining Act, Cap. 123* hereby grant to M/S Zhu Jin Feng (hereinafter called the Licensee) a **Prospecting Licence - Industrial Minerals**, to prospect for **Limestone**, in **Morogoro** District, over an area described in Annex A (hereinafter called the Licence Area), conferring on the Licensee the right to carry on such prospecting operations, abide to Annex B, Annex C and Annex D and execute such other works as are necessary for that purpose.

This Licence, unless sooner cancelled, suspended or surrendered pursuant to the provisions of *The Mining Act, Cap. 123* shall be valid for a period of **forty eight (48)** months, effective from the date of grant.

Granted this 19th day of September 2025

Eng. Ramadhani M. Lwamo
EXECUTIVE SECRETARY

INITIAL PERIOD

From Date	To Date	Prep. Fee and Rent	ERV Number	Date	Signature of ES
Preparation Fee		USD 300.00	925098322923385		
19/09/2025	18/09/2026	USD 3,750.30	925098322923385		

For: EXECUTIVE SECRETARY
MINING COMMISSION

FIRST RENEWAL

I HEREBY CONSENT TO THE FIRST RENEWAL OF PROSPECTING LICENCE NO. of M/S of P. O. Box for Licence Area described in Annex 'A' and conditions prescribed in Annex 'B', 'C' and Annex 'D' for a period of months effective from the day of year

EXECUTIVE SECRETARY

From Date	To Date	Annual Rent	ERV Number	Date	Signature of ES

SECOND RENEWAL

I HEREBY CONSENT TO THE SECOND RENEWAL OF PROSPECTING LICENCE NO. of M/S of P.O. Box for Licence Area described in Annex 'A' and conditions prescribed in Annex 'B', 'C' Annex 'D' for a period of months effective from the day of year

EXECUTIVE SECRETARY

From Date	To Date	Annual Rent	ERV Number	Date	Signature of ES

↑

ANNEX A

DESCRIPTION OF THE LICENCE AREA

Subject to Section 120 of the Mining Act, Cap. 123 the Licence in **Morogoro District**, QDS 202/2, 202/4, 202/3, 202/1 defined by lines of latitude and longitude having the following corner coordinates (Arc 1960):

Corner	Latitude	Longitude
1	- 07 deg. 13 min. 8.22 sec.	38 deg. 11 min. 52.93 sec.
2	- 07 deg. 12 min. 23.90 sec.	38 deg. 12 min. 44.98 sec.
3	- 07 deg. 14 min. 6.71 sec.	38 deg. 12 min. 44.98 sec.
4	- 07 deg. 14 min. 6.71 sec.	38 deg. 13 min. 57.92 sec.
5	- 07 deg. 14 min. 46.27 sec.	38 deg. 13 min. 57.93 sec.
6	- 07 deg. 15 min. 15.49 sec.	38 deg. 14 min. 5.21 sec.
7	- 07 deg. 15 min. 24.41 sec.	38 deg. 14 min. 0.70 sec.
8	- 07 deg. 15 min. 29.21 sec.	38 deg. 14 min. 9.71 sec.
9	- 07 deg. 15 min. 20.02 sec.	38 deg. 14 min. 14.65 sec.
10	- 07 deg. 15 min. 15.48 sec.	38 deg. 14 min. 5.22 sec.
11	- 07 deg. 14 min. 46.67 sec.	38 deg. 13 min. 58.43 sec.
12	- 07 deg. 14 min. 55.06 sec.	38 deg. 16 min. 6.67 sec.
13	- 07 deg. 16 min. 19.39 sec.	38 deg. 16 min. 4.17 sec.
14	- 07 deg. 15 min. 50.62 sec.	38 deg. 12 min. 45.12 sec.
15	- 07 deg. 16 min. 29.95 sec.	38 deg. 12 min. 44.99 sec.
16	- 07 deg. 16 min. 30.14 sec.	38 deg. 11 min. 55.30 sec.
17	- 07 deg. 14 min. 29.13 sec.	38 deg. 09 min. 59.84 sec.
18	- 07 deg. 13 min. 32.25 sec.	38 deg. 11 min. 19.15 sec.
19	- 07 deg. 14 min. 3.20 sec.	38 deg. 11 min. 15.85 sec.
20	- 07 deg. 14 min. 8.68 sec.	38 deg. 11 min. 40.16 sec.
21	- 07 deg. 13 min. 18.75 sec.	38 deg. 11 min. 46.08 sec.

PL 13540/2025

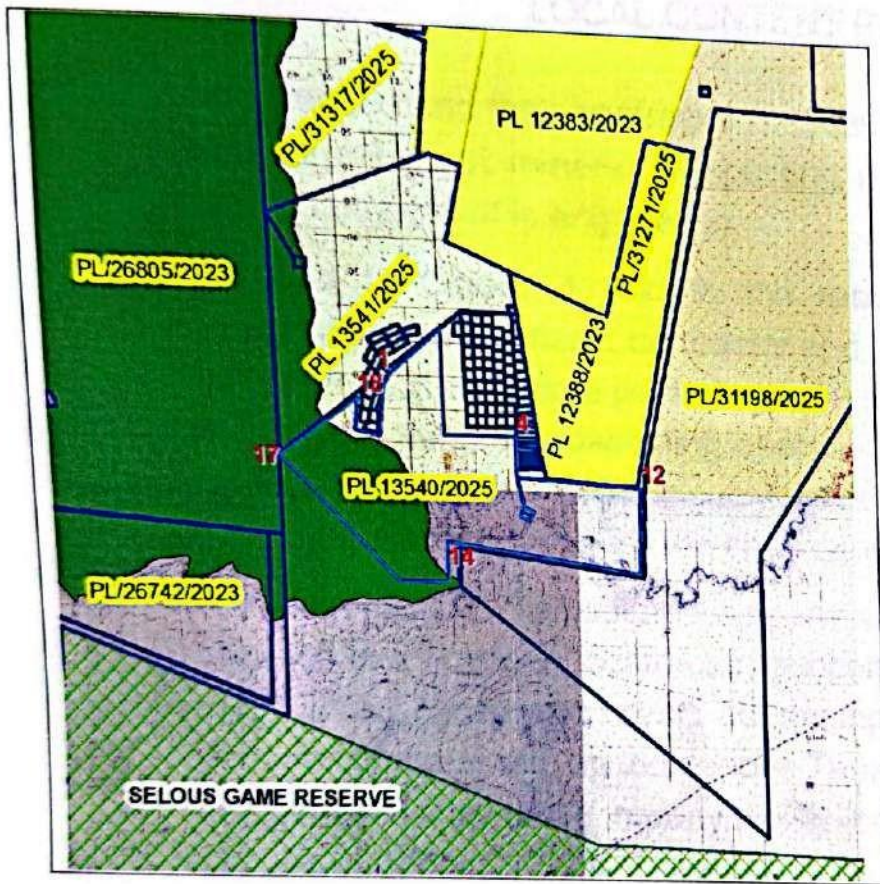

Legend	
Licensed boundary	
Licence Code	PL 13540/2025
District	Morogoro
Direction	

An area of approximately 37.50 Square Kilometres.

ANNEX B

LOCAL CONTENT PLAN

1. The Licensee and their contractor, subcontractor, corporation or other allied entity carrying out mineral prospecting operations shall ensure that local content component is engaged in.
2. Subject to Clause 1 and to the requirement of any law relating to immigration, the Licensee, contractor and its sub-contractor(s) may bring into Tanzania such expatriate personnel as in the Licensee's judgement, required to carry out mineral prospecting operations efficiently and successfully and the Government shall expeditiously provide the necessary work permits and other approvals required for the employment of such expatriate.
3. A non-indigenous Tanzanian company which intends to provide goods or services to a licensee, contractor, subcontractor, corporation or other allied entity within Tanzania carrying out mining activities shall incorporate a joint venture company with an indigenous Tanzanian company and afford that the indigenous Tanzanian company has an equity participation of at least twenty (20%) per centum.
4. The Licensee, contractor, subcontractor, corporation or other allied entity shall procure goods and services (legal, insurance and financial) available in the United Republic of Tanzania in accordance with the approved procurement plan.
5. The Licensee shall on annual basis prepare a credible social responsibility plan jointly agreed by the relevant Local Government Authority or Local Government Authorities in consultation with the Minister responsible for Local Government Authorities and the Minister responsible for Finance.

[Handwritten mark]

PL 13540/2025

ANNEX C

PROSPECTING PROGRAMME AND FINANCIAL EXPENDITURE ESTIMATE.

Subject to Section 40 of *The Mining Act, Cap. 123* and Regulation 9 of the Mining (Mineral Rights) Regulations, 2018, the Licensee shall expend on prospecting operations in respect of the licence granted as per submitted prospecting programme and financial expenditure estimates approved by the Mining Commission.

ANNEX D

INTEGRITY PLEDGE

The Licensee shall comply with the Statement of Integrity Pledge.

g