

THE UNITED REPUBLIC OF TANZANIA
MINISTRY OF MINERALS
MINING COMMISSION

PROSPECTING LICENCE NO. PL 13336/2025

GRANTED PURSUANT TO SECTION 32 OF THE MINING ACT, CAP. 123

WHEREAS M/S HWTZ INVESTMENT LIMITED of P. O. Box 31119, Dar es Saalam, Tanzania has fulfilled the conditions for grant of Prospecting Licence pursuant to Section 31 of *The Mining Act, Cap. 123*;

I, Eng. Ramadhani M. Lwamo, **EXECUTIVE SECRETARY**, subject to the provisions of *The Mining Act, Cap. 123* and of the regulations made thereunder or which may come into force during the continuance of this Licence, or any renewal thereof and pursuant to the powers conferred upon me under Section 32 of *The Mining Act, Cap. 123* hereby grant to M/S HWTZ INVESTMENT LIMITED (hereinafter called the Licensee) a **Prospecting Licence - Metallic Minerals**, to prospect for **Iron Ore**, in **Ludewa District**, over an area described in Annex A (hereinafter called the Licence Area), conferring on the Licensee the right to carry on such prospecting operations, abide to Annex B, Annex C and Annex D and execute such other works as are necessary for that purpose.

This Licence, unless sooner cancelled, suspended or surrendered pursuant to the provisions of *The Mining Act, Cap. 123* shall be valid for a period of **forty eight (48)** months, effective from the date of grant.

Granted this 23rd day of April 2025

Eng. Ramadhani M. Lwamo
EXECUTIVE SECRETARY

INITIAL PERIOD

From Date	To Date	Prep. Fee and Rent	ERV Number	Date	Signature of ES
Prep		USD300	995020999594	03.04.2025	
		USD4567	995020999594	03.04.2025	

FIRST RENEWAL

I HEREBY CONSENT TO THE FIRST RENEWAL OF PROSPECTING LICENCE NO. of M/S of P. O. Box for Licence Area described in Annex 'A' and conditions prescribed in Annex 'B', 'C' and Annex 'D' for a period of months effective from the day of year.....

.....

EXECUTIVE SECRETARY

From Date	To Date	Annual Rent	ERV Number	Date	Signature of ES

SECOND RENEWAL

I HEREBY CONSENT TO THE SECOND RENEWAL OF PROSPECTING LICENCE NO. of M/S of P.O. Box for Licence Area described in Annex 'A' and conditions prescribed in Annex 'B', 'C' Annex 'D' for a period of months effective from the day of year.....

.....

EXECUTIVE SECRETARY

From Date	To Date	Annual Rent	ERV Number	Date	Signature of ES

↑

ANNEX A

DESCRIPTION OF THE LICENCE AREA

Subject to Section 95 of the Mining Act, Cap. 123 the Licence is in **Ludewa District**, QDS 274/3, 274/4 defined by lines of latitude and longitude having the following corner coordinates (Arc 1960):

Corner	Latitude	Longitude
1	- 09 deg. 48 min. 0.00 sec.	34 deg. 44 min. 52.00 sec.
2	- 09 deg. 49 min. 25.00 sec.	34 deg. 44 min. 52.00 sec.
3	- 09 deg. 49 min. 25.00 sec.	34 deg. 45 min. 55.00 sec.
4	- 09 deg. 50 min. 11.00 sec.	34 deg. 45 min. 55.00 sec.
5	- 09 deg. 50 min. 11.00 sec.	34 deg. 47 min. 0.00 sec.
6	- 09 deg. 52 min. 0.00 sec.	34 deg. 47 min. 0.00 sec.
7	- 09 deg. 52 min. 0.00 sec.	34 deg. 46 min. 13.00 sec.
8	- 09 deg. 48 min. 0.00 sec.	34 deg. 39 min. 5.00 sec.

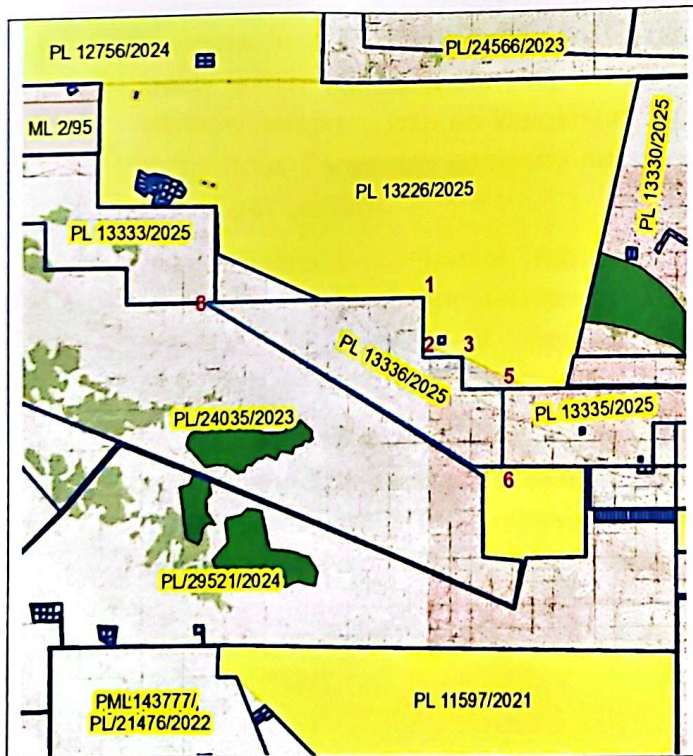

Legend	
Licensed boundary	
Licence Code	PL 13336/2025
District	Ludewa
Direction	

An area of approximately 45.6657 Square Kilometres.



ANNEX B

LOCAL CONTENT PLAN

1. The Licensee and their contractor, subcontractor, corporation or other allied entity carrying out mineral prospecting operations shall ensure that local content component is engaged in.
2. Subject to Clause 1 and to the requirement of any law relating to immigration, the Licensee, contractor and its sub-contractor(s) may bring into Tanzania such expatriate personnel as in the Licensee's judgement, required to carry out mineral prospecting operations efficiently and successfully and the Government shall expeditiously provide the necessary work permits and other approvals required for the employment of such expatriate.
3. A non-indigenous Tanzanian company which intends to provide goods or services to a licensee, contractor, subcontractor, corporation or other allied entity within Tanzania carrying out mining activities shall incorporate a joint venture company with an indigenous Tanzanian company and afford that the indigenous Tanzanian company has an equity participation of at least twenty (20%) per centum.
4. The Licensee, contractor, subcontractor, corporation or other allied entity shall procure goods and services (legal, insurance and financial) available in the United Republic of Tanzania in accordance with the approved procurement plan.
5. The Licensee shall on annual basis prepare a credible social responsibility plan jointly agreed by the relevant Local Government Authority or Local Government Authorities in consultation with the Minister responsible for Local Government Authorities and the Minister responsible for Finance.

9

ANNEX C

PROSPECTING PROGRAMME AND FINANCIAL EXPENDITURE ESTIMATE.

Subject to Section 30 of *The Mining Act, Cap. 123* and Regulation 9 of the Mining (Mineral Rights) Regulations, 2018, the Licensee shall expend on prospecting operations in respect of the licence granted as per submitted prospecting programme and financial expenditure estimates approved by the Mining Commission.

ANNEX D

INTEGRITY PLEDGE

The Licensee shall comply with the Statement of Integrity Pledge.

7