

*Handwritten signature***CERTIFICATE OF OCCUPANCY***(Issued under Section 9 of the Land Ordinance)***Date of Issue:****Title Number:** 9948 LAND REGISTRY, MOSHI**Land Office Number:** 1144952:**Land:** KWAMKORO, KWAMKORO ESTATE AMANI MUHEZA DISTRICT:**Term:** NINETY NINE YEARS:

J. J. J.

16/5/2018

4. The occupier shall not subdivide the land or assign, sublet otherwise dispose of it or part out of it without the previous written consent of the Commissioner for Lands. Any person other than the occupier working or occupying the land otherwise than in the capacity of a servant or contractor of the occupier shall be deemed to be sub-tenant for the purposes of this condition.

5. The Right shall confer no water right.

6. The Occupier shall pay to the Minister on demand made by the Commissioner for Lands on his behalf any further fees or stamp duties which may be discovered to be payable by him in connection with the Right.

7. The President may revoke the Right for failure by the occupier to comply with the conditions expressly or impliedly contained in the Right and in the Public interest.

SCHEDULE

ALL that land known as Kwankoro, Kwankoro Estate WYANI Mueha District measuring One thousand two hundred and thirty two (1232) acres shown for identification only edged red on the plan attached to this Certificate and defined on registered survey plan numbered 12614 deposited at the Office of the Director of Surveys and Mapping at Dar es Salaam.

GIVEN under my hand and seal any by Order of the Minister the day and year first above written.

COMMISSIONER FOR LANDS.

WE the within-named EAST USUKUARA TEA COMPANY LIMITED hereby accept the terms and condition contained in the foregoing Certificate of Occupancy.

SEALED with the COMMON SEAL of the said EAST USUKUARA TEA COMPANY LIMITED and DELIVERED in the presence of us this

10th day of MAY 1993

Signature:..... *D. R. W. J.*.....

Postal Address: P.O. BOX 2535 DAR ES SALAAM

Qualification: DIRECTOR.....

Signature:..... *N. J. J.*.....

Postal Address:.....

Qualification:.....

1-224 751

AWAMKORO

Bombani (KAWAMKORO)

144952

MAYORA ESTATE

Area 1000 sq. ft.

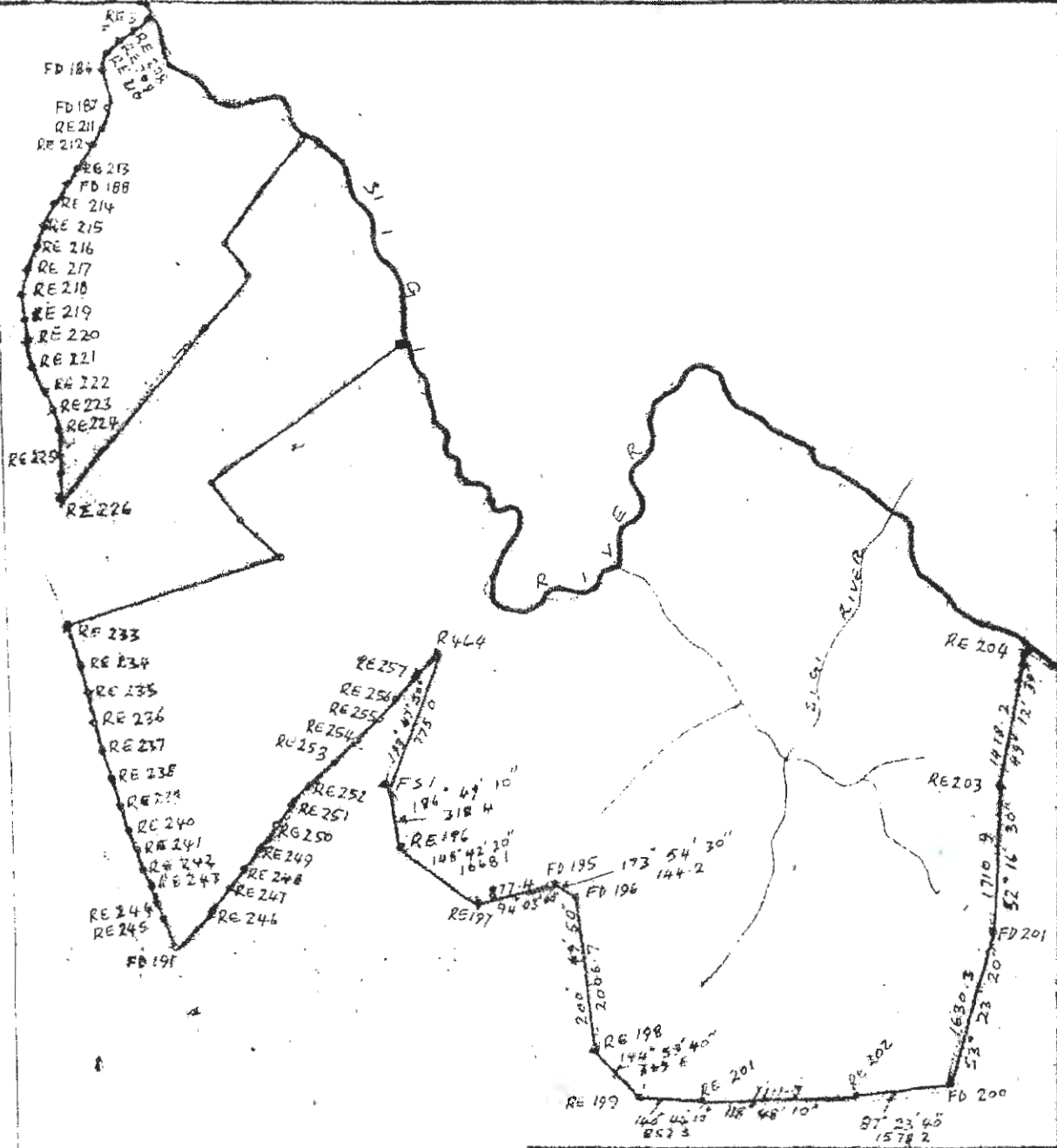

I, the undersigned, being a duly qualified and licensed Surveyor, do hereby certify that the above is a true and correct copy of the original plan as filed in my office.

The above plan is approved for the purposes of the Land Registration Ordinance.

Date: 30-4-93

[Signature]

[Handwritten signature]
16/8/2018

IND. 19845
20080-20080
AT 100 400

249429

16-3-2018 1100P

LAND PARTITIONED INTO 2 PAGES
BLS IN ACCORDANCE WITH PLAN
ATTACHED HERE TO.

[Signature]

[Signature]
[Signature]
REG. OFF. OF TITLES Asst. Registrar of Titles

LAND REGISTRY, MOSHI
MORTGAGE
Filed Document No. 20080
Date of registration 8-9-2006 time 1:00 P.M.
To NATIONAL BANK OF COMMERCE
LIMITED (To secure an Unspecified
Amount) including title nos. 2811, 2812, 2813, 2814,
2815, 2816, 2817, 2818, 2819, 2820, 15052, 15063 & 15674.
[Stamp: CANCELLED]
Asst. Registrar of Titles

[Signature]
16/8/2018

LAND REGISTRY, MOSHI
MORTGAGE DISCHARGE
Filed Document No. 20080 ON 22-3-2018
Date of registration 8-9-2006 time 1:00 P.M.
To NATIONAL BANK OF COMMERCE
LIMITED (To secure an Unspecified
Amount) including title nos. 2811, 2812,
2813, 2814, 2815, 2816, 2817, 2818, 2819,
15052, 15063 & 15674.
[Signature]
Asst. Registrar of Titles

LAND REGISTRY, MOSHI
MORTGAGE
Filed Document No. 43603
Date of registration 22-3-2018 time 1:00 P.M.
To BANK M(TANTANIA) PLC
P.O. BOX 96 - MOC ES
(To secure Unspecified Amount).
[Signature]