

**ACKNOWLEDGEMENT AND RECORDING IN THE CENTRAL REGISTER THE TRANSFER OF PROSPECTING LICENCE**

I, **Eng. Ramadhani M. Lwamo**, Acting Executive Secretary pursuant to Section 123(1) of the Mining Act, Cap. 123 hereby confirm recording in the Central Register the transfer of **100%** shares of Prospecting Licence No. **PL11953/2022** from **M/S DORAH FLUGENCE KINYAIYA** to **M/S CHONGYUAN HUIJIN (TANZANIA) CO. LIMITED**.

The foregoing transfer has been duly recorded on terms and conditions contained in the above **Prospecting Licence, Deed of Transfer and the Mining Act, Cap.123**.

**IN WITNESS WHEREOF** this transfer of Prospecting Licence has been duly recorded

this .....<sup>14<sup>th</sup></sup>.....day of .....<sup>January</sup>.....2025.

  
Eng. Ramadhani M. Lwamo  
**ACTING EXECUTIVE SECRETARY**  
**MINING COMMISSION**



THE UNITED REPUBLIC OF TANZANIA  
MINISTRY OF MINERALS  
MINING COMMISSION

PROSPECTING LICENCE NO. PL 11953/2022

GRANTED PURSUANT TO SECTION 32 OF THE MINING ACT, CAP. 123

WHEREAS M/S Dora Fulgence Kinyaiya of P.O.Box 71749 Dar es salaam, Tanzania has fulfilled the conditions for grant of Prospecting Licence pursuant to Section 31 of *The Mining Act, Cap. 123*;

I, Eng. Yahya I. Samamba, **ACTING EXECUTIVE SECRETARY**, subject to the provisions of *The Mining Act, Cap. 123* and of the regulations made thereunder or which may come into force during the continuance of this Licence, or any renewal thereof and pursuant to the powers conferred upon me under Section 32 of *The Mining Act, Cap. 123* hereby grant to M/S Dora Fulgence Kinyaiya (hereinafter called the Licensee) a **Prospecting Licence - Metallic Minerals**, to prospect for **Gold**, at Chato, in Chato District, over an area described in Annex A (hereinafter called the Licence Area), conferring on the Licensee the right to carry on such prospecting operations, abide to Annex B, Annex C and Annex D and execute such other works as are necessary for that purpose.

This Licence, unless sooner cancelled, suspended or surrendered pursuant to the provisions of *The Mining Act, Cap. 123* shall be valid for a period of **forty eight (48)** months, effective from the date of grant.

Granted this ..... 08 ..... day of ..... JUNE ..... 2022

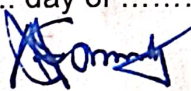
  
Eng. Yahya I. Samamba  
**ACTING EXECUTIVE SECRETARY**



**INITIAL PERIOD**

From Date	To Date	Prep. Fee and Rent	ERV Number	Date	Signature of ES
Preparation		USD 300	922158110455364	07.06.2022	<i>[Signature]</i>
08.06.2022	07.06.2023	USD1,901	922158110455364	07.06.2022	<i>[Signature]</i>

MINING COMMISSION

**FIRST RENEWAL**

I HEREBY CONSENT TO THE FIRST RENEWAL OF PROSPECTING LICENCE NO. .... of M/S ..... of P. O. Box ..... for Licence Area described in Annex 'A' and conditions prescribed in Annex 'B', 'C' and Annex 'D' for a period of ..... months effective from the ..... day of ..... year .....

**ACTING EXECUTIVE SECRETARY**

From Date	To Date	Annual Rent	ERV Number	Date	Signature of ES

**SECOND RENEWAL**

I HEREBY CONSENT TO THE SECOND RENEWAL OF PROSPECTING LICENCE NO. .... of M/S ..... of P.O. Box ..... for Licence Area described in Annex 'A' and conditions prescribed in Annex 'B', 'C' Annex 'D' for a period of ..... months effective from the ..... day of ..... year .....

**ACTING EXECUTIVE SECRETARY**

From Date	To Date	Annual Rent	ERV Number	Date	Signature of ES



## ANNEX A

## DESCRIPTION OF THE LICENCE AREA

Subject to Section 95 of the Mining Act, Cap. 123 the Licence is at Chato area in Chato District, QDS 31/4 defined by lines of latitude and longitude having the following corner coordinates (Arc 1960):

Corner	Latitude	Longitude
1	- 02 deg. 54 min. 0.00 sec.	31 deg. 54 min. 43.50 sec.
2	- 02 deg. 54 min. 13.91 sec.	31 deg. 54 min. 43.50 sec.
3	- 02 deg. 54 min. 12.99 sec.	31 deg. 54 min. 38.00 sec.
4	- 02 deg. 54 min. 28.00 sec.	31 deg. 54 min. 36.00 sec.
5	- 02 deg. 54 min. 29.00 sec.	31 deg. 54 min. 42.00 sec.
6	- 02 deg. 54 min. 29.00 sec.	31 deg. 54 min. 43.50 sec.
7	- 02 deg. 55 min. 6.38 sec.	31 deg. 54 min. 43.49 sec.
8	- 02 deg. 55 min. 1.96 sec.	31 deg. 52 min. 30.59 sec.
9	- 02 deg. 54 min. 59.03 sec.	31 deg. 52 min. 34.76 sec.
10	- 02 deg. 54 min. 46.94 sec.	31 deg. 52 min. 25.81 sec.
11	- 02 deg. 54 min. 53.86 sec.	31 deg. 52 min. 16.09 sec.
12	- 02 deg. 54 min. 50.00 sec.	31 deg. 52 min. 13.00 sec.
13	- 02 deg. 54 min. 53.00 sec.	31 deg. 52 min. 8.00 sec.
14	- 02 deg. 55 min. 2.00 sec.	31 deg. 52 min. 11.00 sec.
15	- 02 deg. 55 min. 12.00 sec.	31 deg. 52 min. 9.00 sec.
16	- 02 deg. 55 min. 12.00 sec.	31 deg. 52 min. 21.90 sec.
17	- 02 deg. 55 min. 33.90 sec.	31 deg. 52 min. 21.90 sec.
18	- 02 deg. 55 min. 33.90 sec.	31 deg. 49 min. 55.00 sec.
19	- 02 deg. 54 min. 0.00 sec.	31 deg. 49 min. 55.00 sec.
20	- 02 deg. 54 min. 0.00 sec.	31 deg. 53 min. 16.01 sec.
21	- 02 deg. 54 min. 13.00 sec.	31 deg. 53 min. 16.01 sec.
22	- 02 deg. 54 min. 10.00 sec.	31 deg. 53 min. 4.00 sec.
23	- 02 deg. 54 min. 17.00 sec.	31 deg. 53 min. 4.00 sec.
24	- 02 deg. 54 min. 21.00 sec.	31 deg. 53 min. 16.01 sec.
25	- 02 deg. 54 min. 33.99 sec.	31 deg. 53 min. 16.00 sec.
26	- 02 deg. 54 min. 33.99 sec.	31 deg. 54 min. 22.00 sec.
27	- 02 deg. 54 min. 0.00 sec.	31 deg. 54 min. 22.00 sec.



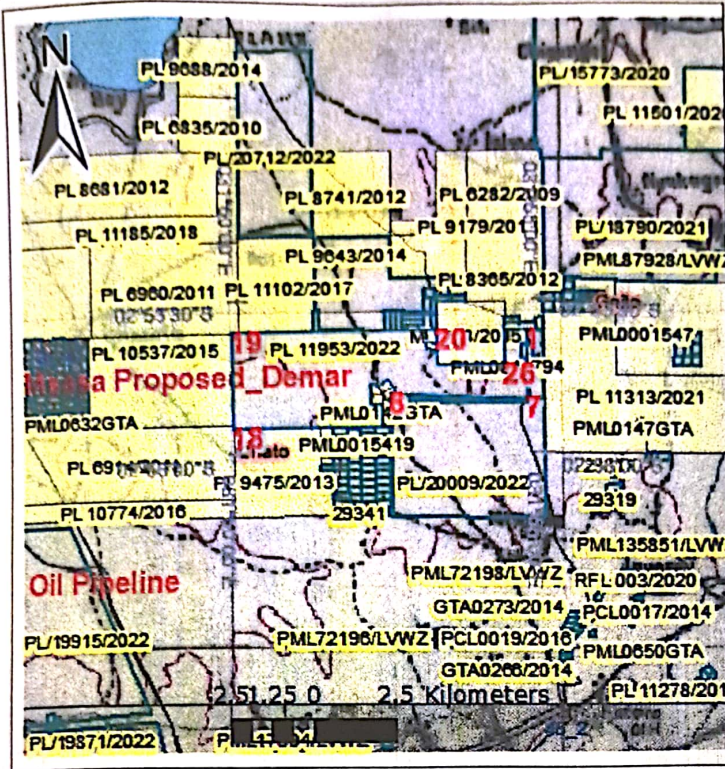

Legend	
Licensed boundary	
License Code	PL 11953/2022
District	Chato, Geita
Direction	

An area of approximately 19.01 Square Kilometres.



## LOCAL CONTENT PLAN

1. The Licensee and their contractor, subcontractor, corporation or other allied entity carrying out mineral prospecting operations shall ensure that local content component is engaged in.
2. Subject to Clause 1 and to the requirement of any law relating to immigration, the Licensee, contractor and its sub-contractor(s) may bring into Tanzania such expatriate personnel as in the Licensee's judgement, required to carry out mineral prospecting operations efficiently and successfully and the Government shall expeditiously provide the necessary work permits and other approvals required for the employment of such expatriate.
3. A non-indigenous Tanzanian company which intends to provide goods or services to a licensee, contractor, subcontractor, corporation or other allied entity within Tanzania carrying out mining activities shall incorporate a joint venture company with an indigenous Tanzanian company and afford that the indigenous Tanzanian company has an equity participation of at least twenty (20%) per centum.
4. The Licensee, contractor, subcontractor, corporation or other allied entity shall procure goods and services (legal, insurance and financial) available in the United Republic of Tanzania in accordance with the approved procurement plan.
5. The Licensee shall on annual basis prepare a credible social responsibility plan jointly agreed by the relevant Local Government Authority or Local Government Authorities in consultation with the Minister responsible for Local Government Authorities and the Minister responsible for Finance.



PROSPECTING PROGRAMME AND FINANCIAL EXPENDITURE ESTIMATE.

Subject to Section 30 of *The Mining Act, Cap. 123* and Regulation 9 of the Mining (Mineral Rights) Regulations, 2018, the Licensee shall expend on prospecting operations in respect of the licence granted as per submitted prospecting programme and financial expenditure estimates approved by the Mining Commission.

INTEGRITY PLEDGE

The Licensee shall comply with the Statement of Integrity Pledge.

